

CONSTRUCTION DOCUMENTS FOR ENTRY SIDEWALK IMPROVEMENTS SCCD FAIRFIELD CAMPUS

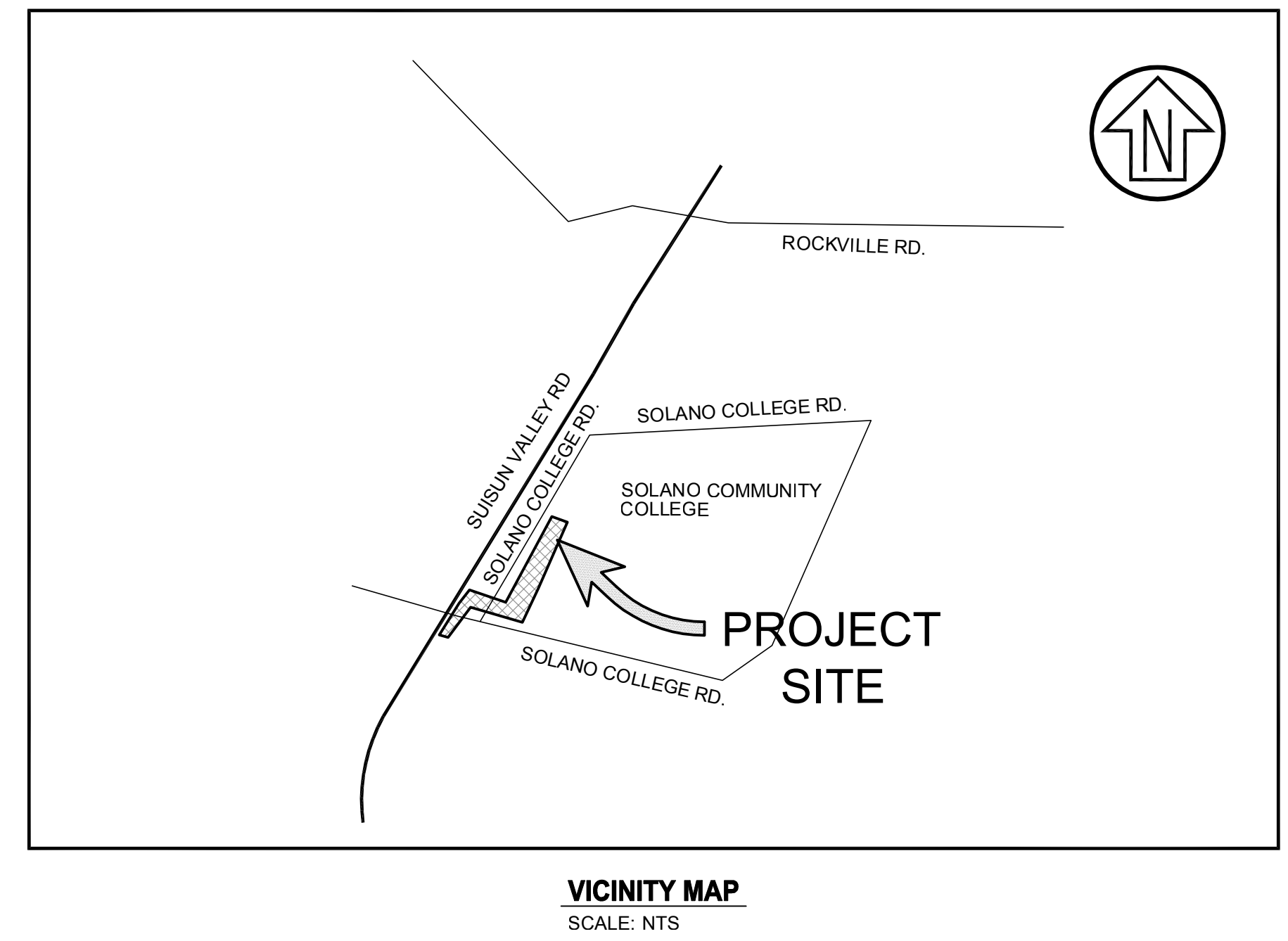

LEGEND

EXISTING		PROPOSED
	BOLLARD	N/A
	SIGN	N/A
	LIGHT - POST MOUNTED	N/A
	POWER POLE (WITH GUY)	N/A
	SANITARY SEWER - CLEANOUT	N/A
	STORM DRAINAGE - AREA DRAIN	N/A
	STORM DRAINAGE - CLEANOUT	N/A
	STORM DRAINAGE - CATCH BASIN	N/A
	STORM DRAINAGE - CURB INLET	N/A
	STORM DRAINAGE - DROP INLET	N/A
	TRAFFIC LIGHT	N/A
	FOUND / SET - CONTROL POINT	N/A
	CONTOUR - MAJOR	
	CONTOUR - MINOR	
	CURB, GUTTER AND SIDEWALK	
	FENCE	
	FLOWLINE / SWALE	
	RIGHT OF WAY	
	RETAINING WALL	
	SANITARY SEWER	
	STORM DRAIN	
	TREE DRIPLINE	N/A

GENERAL NOTES

- WORK SHOWN HEREON SHALL BE DONE IN ACCORDANCE WITH THE CITY OF FAIRFIELD STANDARD CONSTRUCTION PLANS AND SPECIFICATIONS, LATEST EDITION, SOLANO COMMUNITY COLLEGE STANDARD PLANS AND DETAILS, THE STANDARD SPECIFICATIONS FOR THE STATE OF CALIFORNIA DEPARTMENT OF TRANSPORTATION, LATEST EDITION, AND THE APPLICABLE UTILITY AGENCY STANDARD PLANS AND SPECIFICATIONS, LATEST EDITION.
- THE CONTRACTOR SHALL ASSUME SOLE AND COMPLETE RESPONSIBILITY FOR THE JOB SITE CONDITIONS, INCLUDING SAFETY OF ALL PERSONS AND PROPERTY, DURING THE COURSE OF CONSTRUCTION OF THIS PROJECT. THIS REQUIREMENT SHALL APPLY CONTINUOUSLY, AND SHALL NOT BE LIMITED TO NORMAL WORKING HOURS. THE CONTRACTOR FURTHER AGREES TO HOLD DESIGN PROFESSIONAL HARMLESS FROM ANY AND ALL LIABILITY, REAL OR ALLEGED, IN CONNECTION WITH THE PERFORMANCE OF WORK ON THIS PROJECT, EXCEPTING LIABILITY ARISING FROM THE SOLE NEGLIGENCE OF THE DESIGN PROFESSIONAL.
- CONTRACTOR SHALL HOLD HARMLESS SOLANO COMMUNITY COLLEGE AND ITS AUTHORIZED REPRESENTATIVES FROM ALL LIABILITIES AND DAMAGES RESULTING FROM HIS CONSTRUCTION OPERATIONS.
- PRIOR TO COMMENCING CONSTRUCTION OPERATIONS, THE CONTRACTOR SHALL VERIFY ALL INTERFACES BETWEEN EXISTING CONDITIONS AND NEW CONSTRUCTION FOR GRADING, DRAINAGE, UNDERGROUND, AND OVERHEAD FACILITIES, INCLUDING LOCATION AND ELEVATION OF EXISTING UNDERGROUND OR AT GRADE FACILITIES AT CROSSINGS WITH PROPOSED UNDERGROUND FACILITIES. IF CONDITIONS DIFFER FROM THOSE SHOWN ON THE PLANS, THE CONTRACTOR SHALL NOTIFY THE ENGINEER AND SHALL NOT BEGIN CONSTRUCTION OPERATIONS UNTIL THE CHANGED CONDITIONS HAVE BEEN EVALUATED.
- THE CONTRACTOR SHALL BE RESPONSIBLE FOR THE REVIEW AND COORDINATION OF ALL CONTRACT DOCUMENTS PRIOR TO THE START OF CONSTRUCTION. ANY DISCREPANCIES THAT OCCUR SHALL BE BROUGHT TO THE ATTENTION OF THE ENGINEER PRIOR TO THE START OF CONSTRUCTION SO THAT A CLARIFICATION CAN BE ISSUED. ANY WORK PERFORMED IN CONFLICT WITH THE CONTRACT DOCUMENTS SHALL BE CORRECTED BY THE CONTRACTOR AT THEIR OWN EXPENSE.
- THE ENGINEER PREPARING THESE PLANS WILL NOT BE RESPONSIBLE FOR, OR LIABLE FOR, UNAUTHORIZED CHANGES TO OR USES OF THESE PLANS. ALL CHANGES TO THE PLANS MUST BE IN WRITING AND MUST BE APPROVED BY THE ENGINEER.
- NOTES AND DETAILS ON DRAWINGS SHALL TAKE PRECEDENCE OVER GENERAL NOTES AND TYPICAL DETAILS. WHERE NO DETAILS ARE GIVEN, CONSTRUCTION SHALL BE AS SHOWN FOR SIMILAR WORK.
- ALL EASEMENTS OR OTHER ENCUMBRANCES SHOWN OR REFERENCED IN THESE PLANS OR DISCLOSED IN THE TITLE REPORT ARE SUBJECT TO INHERENT OR EXPLICIT RESTRICTIONS. THE CONTRACTOR IS RESPONSIBLE FOR DETERMINING THE IMPACT OF THESE RESTRICTIONS ON HIS OR HER INTENT FOR THE PROPERTY.
- THE CONTRACTOR SHALL OBTAIN ALL NECESSARY PERMITS FROM THE CITY OF FAIRFIELD AND APPROPRIATE JURISDICTIONAL AGENCIES FOR DISCHARGE OF GROUNDWATER THAT MAY BE NECESSARY TO ACCOMPLISH WORK SHOWN ON THESE PLANS.
- WATER SHALL BE USED TO CONTROL DUST DURING CONSTRUCTION OPERATIONS.
- OUTDOOR NOISE-GENERATING CONSTRUCTION ACTIVITIES (INCLUDING BUT NOT LIMITED TO RAPID IMPACT COMPACTION (RIC) GRADING, TRENCHING, CONCRETE PLACEMENT, SAWING AND HAMMERING) SHALL BE LIMITED TO THE HOURS BETWEEN 8 AM. AND 5PM, MONDAY THROUGH FRIDAY. FOR QUESTIONS REGARDING CONSTRUCTION HOURS AND/OR RELATED NOISE, PLEASE CONTACT THE ENGINEER.
- THE CONTRACTOR SHALL NOTIFY THE GEOTECHNICAL ENGINEER 48 HOURS PRIOR TO COMMENCING WORK. THE GEOTECHNICAL ENGINEER SHALL OBSERVE CONSTRUCTION TO VERIFY THAT EXISTING AND INSTALLED CONDITIONS ARE CONSISTENT WITH THE GEOTECHNICAL REPORT.
- IF, AT ANY TIME DURING GRADING OPERATIONS, ANY UNFAVORABLE GEOLOGICAL CONDITIONS ARE ENCOUNTERED, GRADING IN THAT AREA WILL STOP UNTIL APPROVED CORRECTIVE MEASURES ARE OBTAINED.
- ALL GRADED BANK TOPS AND TOES SHALL BE ROUNDED.
- ALL RAMP AND OTHER ACCESSIBILITY ACCOMMODATIONS ARE INTENDED TO COMPLY WITH THE CURRENT STANDARDS UNDER THE AMERICANS WITH DISABILITIES ACT. THE CONTRACTOR SHALL NOTIFY THE ENGINEER IF ANY PROPOSED IMPROVEMENTS ARE NOT CONSISTENT WITH THE STANDARDS.
- ALL STREETS SHALL BE SWEEPED AND KEPT CLEAN AT THE END OF EACH DAY AND SHALL COMPLY WITH ALL APPLICABLE MCSTOPPP, NPDES REQUIREMENTS FOR THE DURATION OF THE PROJECT WORK.
- THE CONTRACTOR SHALL CONTACT UNDERGROUND SERVICE ALERT (811) A MINIMUM OF 48 HOURS PRIOR TO EXCAVATION.
- THE CONTRACTOR SHALL OBTAIN AN O.S.H.A. PERMIT FROM THE CALIFORNIA DIVISION OF INDUSTRIAL SAFETY PRIOR TO THE CONSTRUCTION OF TRENCHES OR EXCAVATIONS WHICH ARE 5'OR DEEPER. ALL TRENCHES 5' IN DEPTH OR GREATER SHALL BE SHORED AND BRACED ACCORDING TO STATE LAW.
- UTILITIES AS SHOWN CONFORM TO AVAILABLE RECORD DATA. THE EXISTENCE, LOCATION AND CHARACTERISTICS OF UNDERGROUND UTILITY INFORMATION SHOWN ON THESE PLANS HAVE BEEN OBTAINED FROM A REVIEW OF AVAILABLE RECORD DATA. NO REPRESENTATION IS MADE AS TO THE ACCURACY OR COMPLETENESS OF SAID UTILITY INFORMATION. IT IS THE CONTRACTOR'S RESPONSIBILITY TO VERIFY LOCATION AND DEPTHS BY POT-HOLING OF ALL UTILITIES WITH APPROPRIATE AGENCIES, AND TO TAKE PRECAUTIONARY MEASURES TO PROTECT THE UTILITY LINES SHOWN AND ANY OTHER LINES NOT OF RECORD OR NOT SHOWN ON THESE PLANS. ANY CONFLICTS SHALL BE REPORTED IMMEDIATELY TO THE ENGINEER.
- CONTRACTOR SHALL PROVIDE ALL MATERIAL, LABOR, EQUIPMENT, FOR INSTALLATION, IMPLEMENTATION, AND MAINTENANCE OF ALL SURFACE WATER POLLUTION PREVENTION MEASURES THROUGHOUT THE FULL EXTENT OF THE PROJECT.
- THIS SURVEY DOES NOT REFLECT A FINAL BOUNDARY DETERMINATION. THE BOUNDARY SHOWN HEREON IS DEPICTED FOR GRAPHICAL PURPOSES ONLY.
- DISTANCES SHOWN ARE IN FEET AND DECIMALS THEREOF.
- HORIZONTAL AND VERTICAL DATUM IS BASED ON LOCALIZATION OF AERIAL SURVEY CONTROL PROVIDED BY SOLANO COLLEGE.
- THESE PLANS COMPLY WITH ALL CURRENT APPLICABLE ADA/ADAG FOR PROW LAWS AT THE TIME OF PREPARATION.



SHEET INDEX

- C0.0 COVER SHEET AND GENERAL NOTES**
- C1.0 SIDEWALK IMPROVEMENT PLAN**
- C1.1 SIDEWALK IMPROVEMENT PLAN**
- C2.0 DETAILS AND SECTIONS**
- C2.1 CURB RAMP GRADING AND LAYOUT DETAILS**

ABBREVIATIONS

AB	AGGREGATE BASE	C&G	CURB AND GUTTER	FG	FINISH GRADE	O.C.	ON CENTER
AC	ASPHALT CONCRETE	CG&SW	CURB, GUTTER AND SIDEWALK	FL	FLOWLINE	P.C.C.	PORTLAND CEMENT CONCRETE
ACR	ACCESS COMPLIANT RAMP	DL	DAYLIGHT	FS	FINISH SURFACE	PRO	PROPOSED
BSW	BACK OF SIDEWALK	EG	EXISTING GRADE	GB	GRADE BREAK	SF	SQUARE FEET
CJ	CONTROL JOINT	EL	ELEVATION	HP	HIGH POINT	SW	SIDEWALK
CL	CENTERLINE / CONTROL LINE	EP	EDGE OF PAVEMENT	JP	JOINT POLE	TC	TOP OF CURB
CP	CONTROL POINT	EX	EXISTING	LF	LINEAR FEET	TP	TOP OF PAVEMENT
CR	CURB RETURN	FC	FACE OF CURB	LP	LOW POINT	UNO	UNLESS NOTED OTHERWISE
				NTS	NOT TO SCALE		

BASIS OF TOPOGRAPHY

TOPOGRAPHY SHOWN WAS PERFORMED BY FIELD SURVEY ON SEPTEMBER 9, 2016

BENCHMARK

VERTICAL DATUM IS BASED ON LOCALIZATION OF AERIAL SURVEY CONTROL FROM MOUNTAIN PACIFIC SURVEYS DATED 2012, AND PROVIDED BY SOLANO COLLEGE

BASIS OF BEARINGS

HORIZONTAL CONTROL IS BASED ON LOCALIZATION OF AERIAL SURVEY CONTROL FROM MOUNTAIN PACIFIC SURVEYS DATED 2012, AND PROVIDED BY SOLANO COLLEGE.

APPROVAL:	DATE: _____
_____	_____
TRAFFIC ENGINEER	
_____	_____
RCE #	EXPIRATION

THIS SIGNATURE IN NO WAY RELIEVES THE DESIGN ENGINEER OF LIABILITY. THIS SIGNATURE SIGNIFIES THAT THE WORK IS IN GENERAL CONFORMANCE OF THE CITY'S GUIDELINES, PRACTICES, POLICIES, GENERAL PROVISIONS, AND SPECIFICATIONS.

Rev	Date	Description	Designed	Drawn	Checked
-	06/19/17	ISSUED FOR BID/NOT FOR CONSTRUCTION	SAS	SAS	KSB

CSW ST2
CSW/Stuber-Stroeh Engineering Group, Inc.
 Civil & Structural Engineers | Surveying & Mapping | Environmental Planning
 Land Planning | Construction Management
 45 Leveroni Court, Novato, CA 94949
 tel: 415.883.9850 fax: 415.883.9835
 http://www.cswst2.com © 2017

City	FAIRFIELD
County	SOLANO
State	CALIFORNIA

SOLANO COMMUNITY COLLEGE
COVER SHEET AND GENERAL NOTES
FAIRFIELD CAMPUS ENTRY SIDEWALK IMPROVEMENT PROJECT

Prepared Under the Direction of:	Sheet
	C0.0
Scale:	N.T.S.
Date:	02/09/2017
Project Number:	4116410
Plan File:	D-5348.01

C:\Users\stuber\appdata\local\temp\AP\stuber_17022017_02\09\PM_88888_11

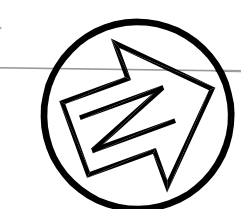
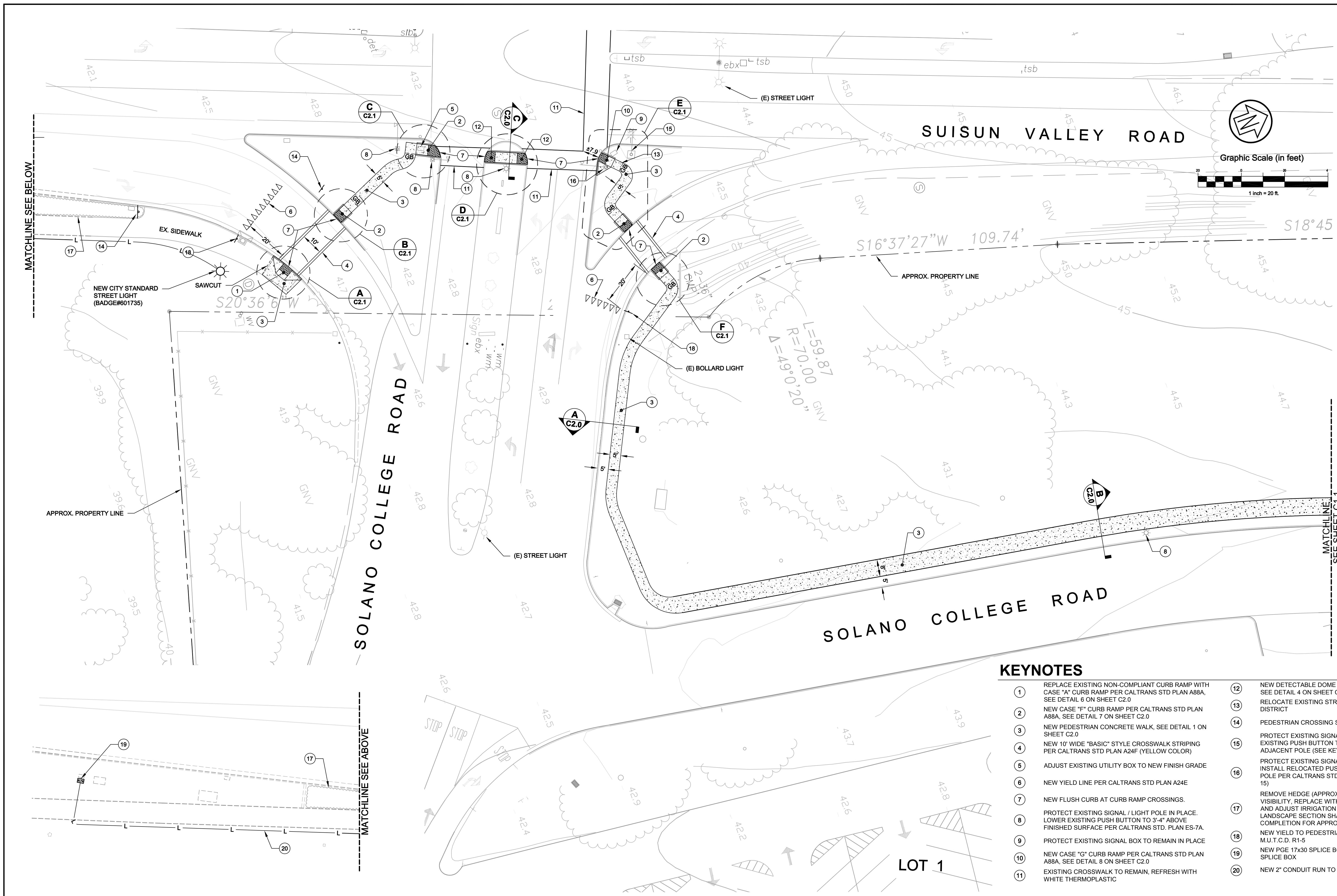

Graphic Scale (in feet)

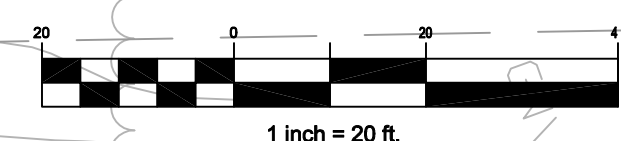

KEYNOTES

- ① REPLACE EXISTING NON-COMPLIANT CURB RAMP WITH CASE "A" CURB RAMP PER CALTRANS STD PLAN A88A, SEE DETAIL 6 ON SHEET C2.0
- ② NEW CASE "F" CURB RAMP PER CALTRANS STD PLAN A88A, SEE DETAIL 7 ON SHEET C2.0
- ③ NEW PEDESTRIAN CONCRETE WALK, SEE DETAIL 1 ON SHEET C2.0
- ④ NEW 10" WIDE "BASIC" STYLE CROSSWALK STRIPING PER CALTRANS STD PLAN A24F (YELLOW COLOR)
- ⑤ ADJUST EXISTING UTILITY BOX TO NEW FINISH GRADE
- ⑥ NEW YIELD LINE PER CALTRANS STD PLAN A24E
- ⑦ NEW FLUSH CURB AT CURB RAMP CROSSINGS.
- ⑧ PROTECT EXISTING SIGNAL / LIGHT POLE IN PLACE. LOWER EXISTING PUSH BUTTON TO 3'-4" ABOVE FINISHED SURFACE PER CALTRANS STD. PLAN ES-7A.
- ⑨ PROTECT EXISTING SIGNAL BOX TO REMAIN IN PLACE
- ⑩ NEW CASE "G" CURB RAMP PER CALTRANS STD PLAN A88A, SEE DETAIL 8 ON SHEET C2.0
- ⑪ EXISTING CROSSWALK TO REMAIN, REFRESH WITH WHITE THERMOPLASTIC
- ⑫ NEW DETECTABLE DOME WARNING AT FLUSH WALK. SEE DETAIL 4 ON SHEET C2.0
- ⑬ RELOCATE EXISTING STREET SIGN AS DIRECTED BY DISTRICT
- ⑭ PEDESTRIAN CROSSING SIGN PER M.U.T.C.D. W11-2
- ⑮ PROTECT EXISTING SIGNAL / LIGHT POLE IN PLACE. EXISTING PUSH BUTTON TO BE RELOCATED TO ADJACENT POLE (SEE KEYNOTE 16)
- ⑯ PROTECT EXISTING SIGNAL / LIGHT POLE IN PLACE. INSTALL RELOCATED PUSH BUTTON FROM ADJACENT POLE PER CALTRANS STD. PLAN ES-7A, (SEE KEYNOTE 15)
- ⑰ REMOVE HEDGE (APPROX. 70 LF) TO IMPROVE SIGHT VISIBILITY, REPLACE WITH TURF SIMILAR TO ADJACENT AND ADJUST IRRIGATION AS NEEDED. THE CITY LANDSCAPE SECTION SHALL BE NOTIFIED OF COMPLETION FOR APPROVAL
- ⑱ NEW YIELD TO PEDESTRIAN CROSSING SIGN PER M.U.T.C.D. R1-5
- ⑲ NEW PGE 17x30 SPLICE BOX CONNECTED TO EXISTING SPLICE BOX
- ⑳ NEW 2" CONDUIT RUN TO NEW STREETLIGHT (±233 LF)

Rev	Date	Description	Designed	Drawn	Checked
-	06/19/17	ISSUED FOR BID/NOT FOR CONSTRUCTION	SAS	SAS	KSB

CSW | ST2
CSW/Stuber-Stroeh Engineering Group, Inc.
 Civil & Structural Engineers | Surveying & Mapping | Environmental Planning
 Land Planning | Construction Management
 45 Leveroni Court | tel: 415.883.9850
 Novato, CA 94949 | fax: 415.883.9835
<http://www.cswst2.com> | © 2017

City	FAIRFIELD
County	SOLANO
State	CALIFORNIA

SOLANO COMMUNITY COLLEGE
SIDEWALK IMPROVEMENT PLAN
FAIRFIELD CAMPUS ENTRY SIDEWALK IMPROVEMENT PROJECT

Prepared Under the Direction of: _____
 Sheet
C1.0
 Scale: 1" = 20'
 Date: 02/09/17
 Project Number: 4116410
 Plan File: D-5348.02

F:\04416410\Drawings\Sheet_C1.0.dwg 06/15/2017 01:59 PM asst 1:1

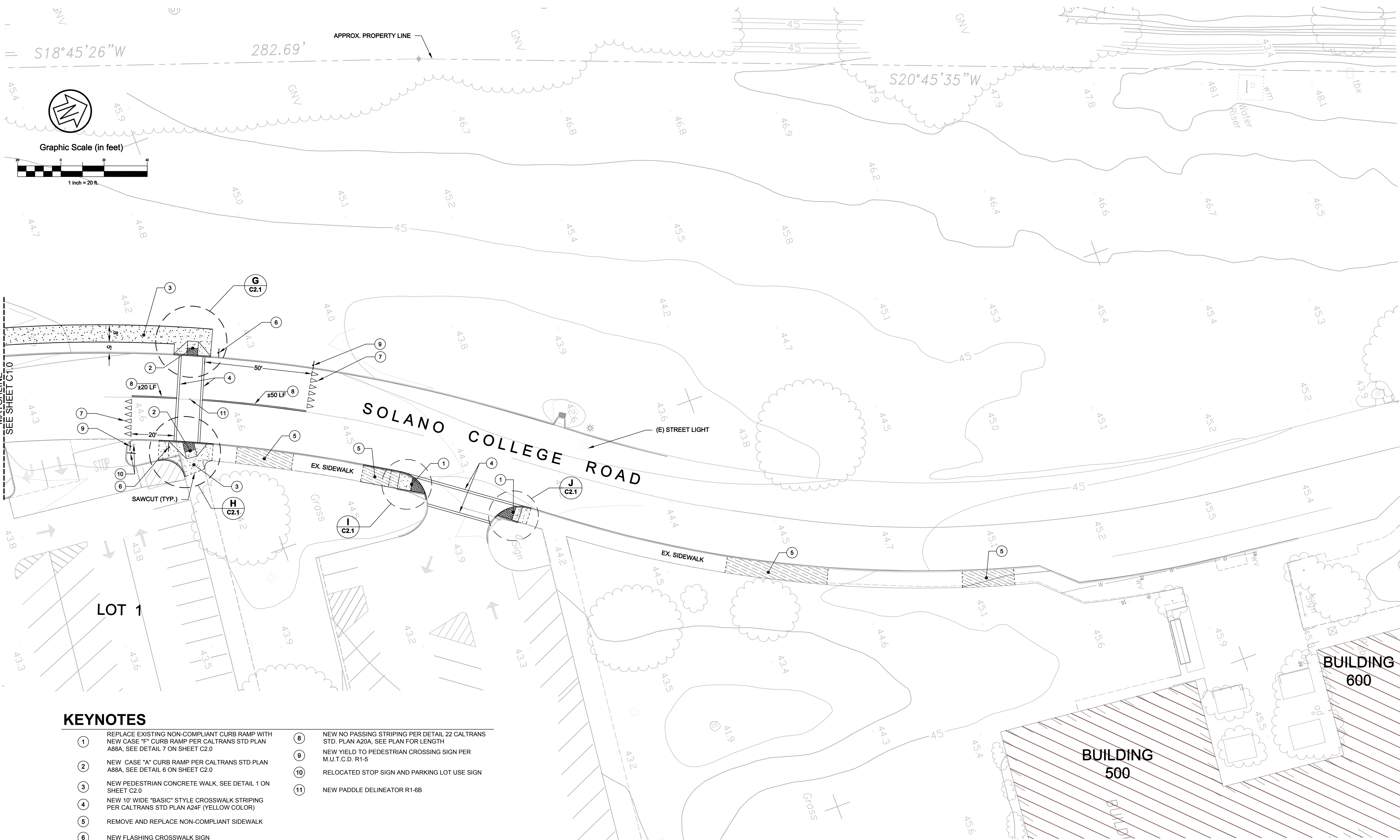

KEYNOTES

- | | | | |
|---|---|----|--|
| 1 | REPLACE EXISTING NON-COMPLIANT CURB RAMP WITH NEW CASE "F" CURB RAMP PER CALTRANS STD PLAN A88A, SEE DETAIL 7 ON SHEET C2.0 | 8 | NEW NO PASSING STRIPING PER DETAIL 22 CALTRANS STD. PLAN A20A, SEE PLAN FOR LENGTH |
| 2 | NEW CASE "A" CURB RAMP PER CALTRANS STD PLAN A88A, SEE DETAIL 6 ON SHEET C2.0 | 9 | NEW YIELD TO PEDESTRIAN CROSSING SIGN PER M.U.T.C.D. R1-5 |
| 3 | NEW PEDESTRIAN CONCRETE WALK, SEE DETAIL 1 ON SHEET C2.0 | 10 | RELOCATED STOP SIGN AND PARKING LOT USE SIGN |
| 4 | NEW 10' WIDE "BASIC" STYLE CROSSWALK STRIPING PER CALTRANS STD PLAN A24F (YELLOW COLOR) | 11 | NEW PADDLE DELINEATOR R1-6B |
| 5 | REMOVE AND REPLACE NON-COMPLIANT SIDEWALK | | |
| 6 | NEW FLASHING CROSSWALK SIGN | | |
| 7 | NEW YIELD LINE PER CALTRANS STD. PLAN A24E | | |

Rev	Date	Description	Designed	Drawn	Checked
-	06/19/17	ISSUED FOR BID/NOT FOR CONSTRUCTION	SAS	SAS	KSB

CSW | ST2
CSW/Stuber-Stroeh Engineering Group, Inc.
 Civil & Structural Engineers | Surveying & Mapping | Environmental Planning
 Land Planning | Construction Management
 45 Leveroni Court tel: 415.883.9850
 Novato, CA 94949 fax: 415.883.9835
<http://www.cswst2.com> © 2017

City	FAIRFIELD
County	SOLANO
State	CALIFORNIA

SOLANO COMMUNITY COLLEGE
SIDEWALK IMPROVEMENT PLAN
FAIRFIELD CAMPUS ENTRY SIDEWALK IMPROVEMENT PROJECT

Prepared Under the Direction of:	Sheet
	C1.1
Scale:	1" = 20'
Date:	02/09/17
Project Number:	4116410
Plan File:	D-5348.03

P:\04116410\Drawings\Sheet_Drawing\C1.1.dwg 06/15/2017 01:29 PM asst 1:1

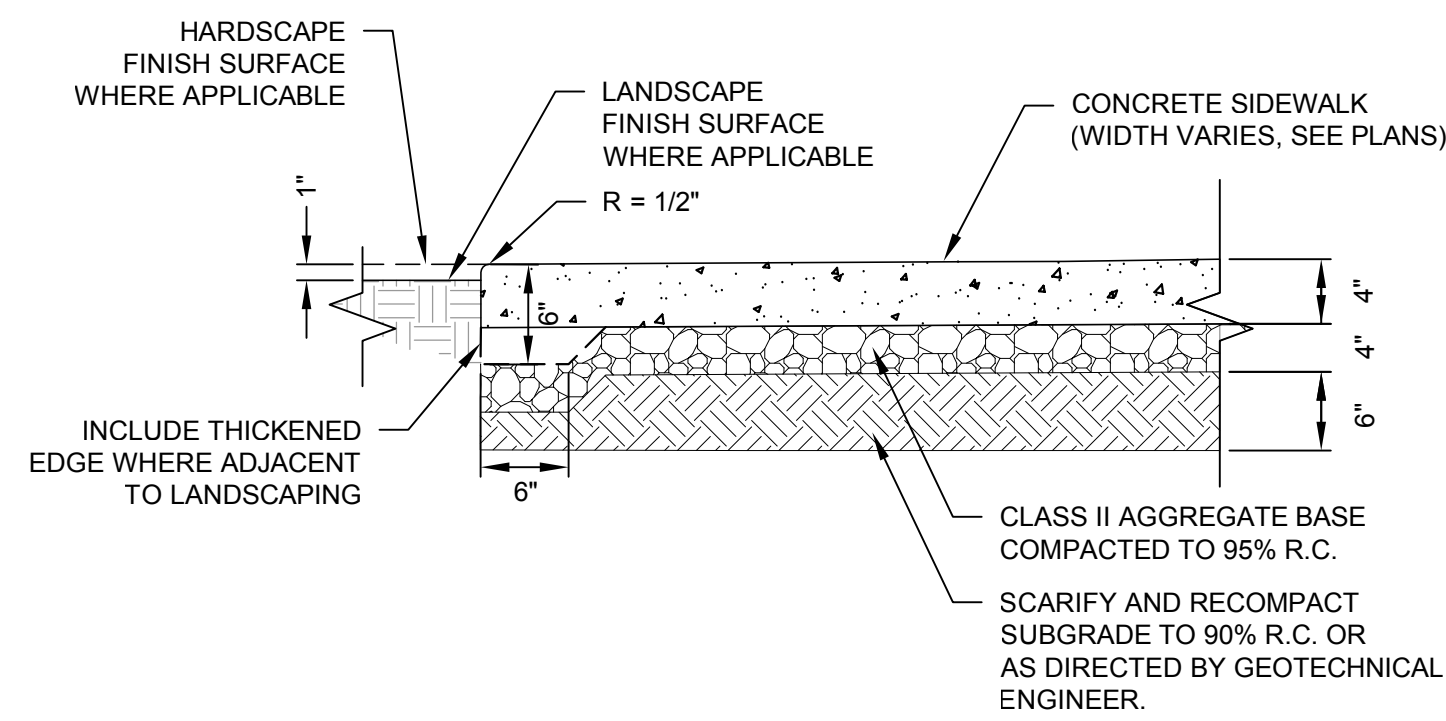

1 PEDESTRIAN CONCRETE SIDEWALK DETAIL (SCCD STANDARD DETAIL NO. 110)
SCALE: 1" = 1'

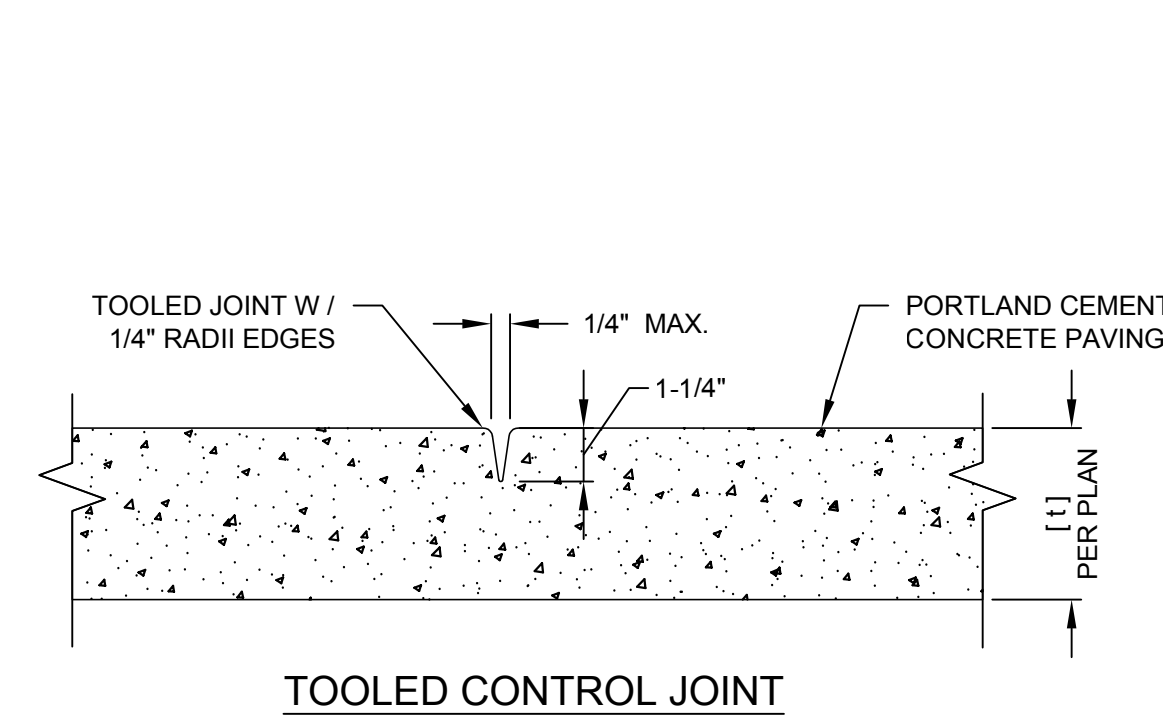

2 CONTROL JOINT FOR PEDESTRIAN CONCRETE PAVEMENT
SCALE: 1" = 1'

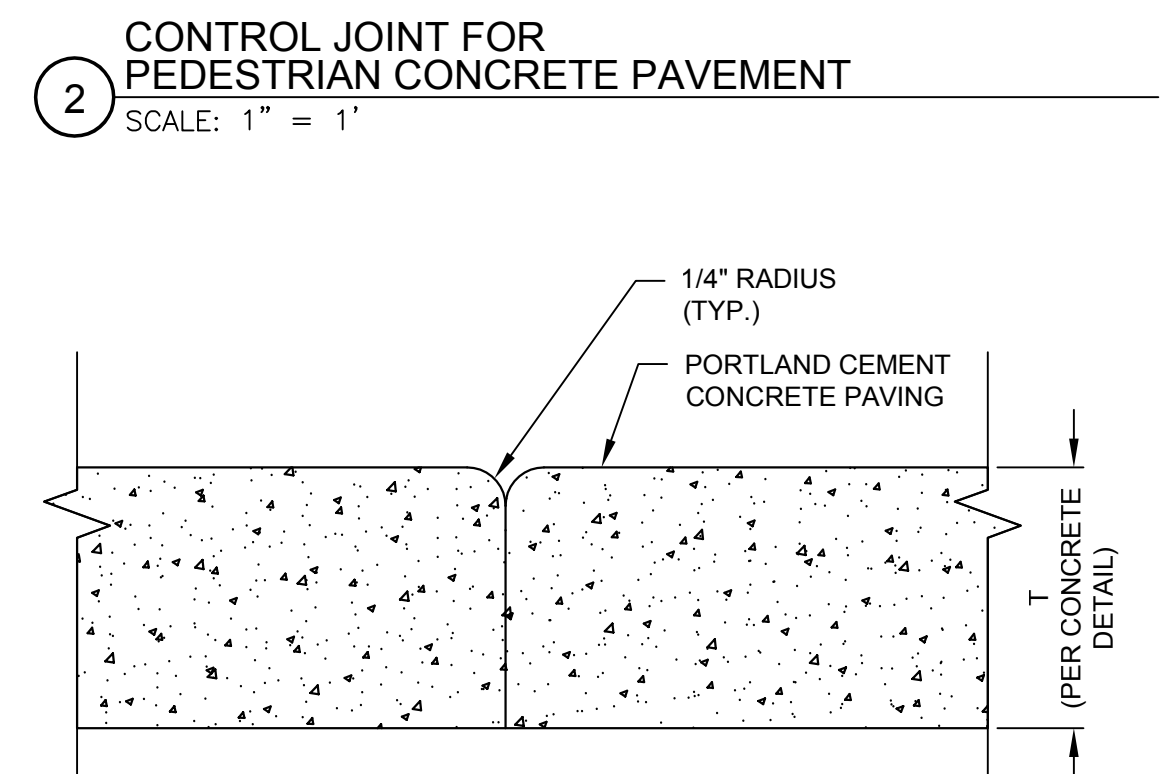

3 CONSTRUCTION JOINT FOR CONCRETE WALKWAYS
SCALE: N.T.S.

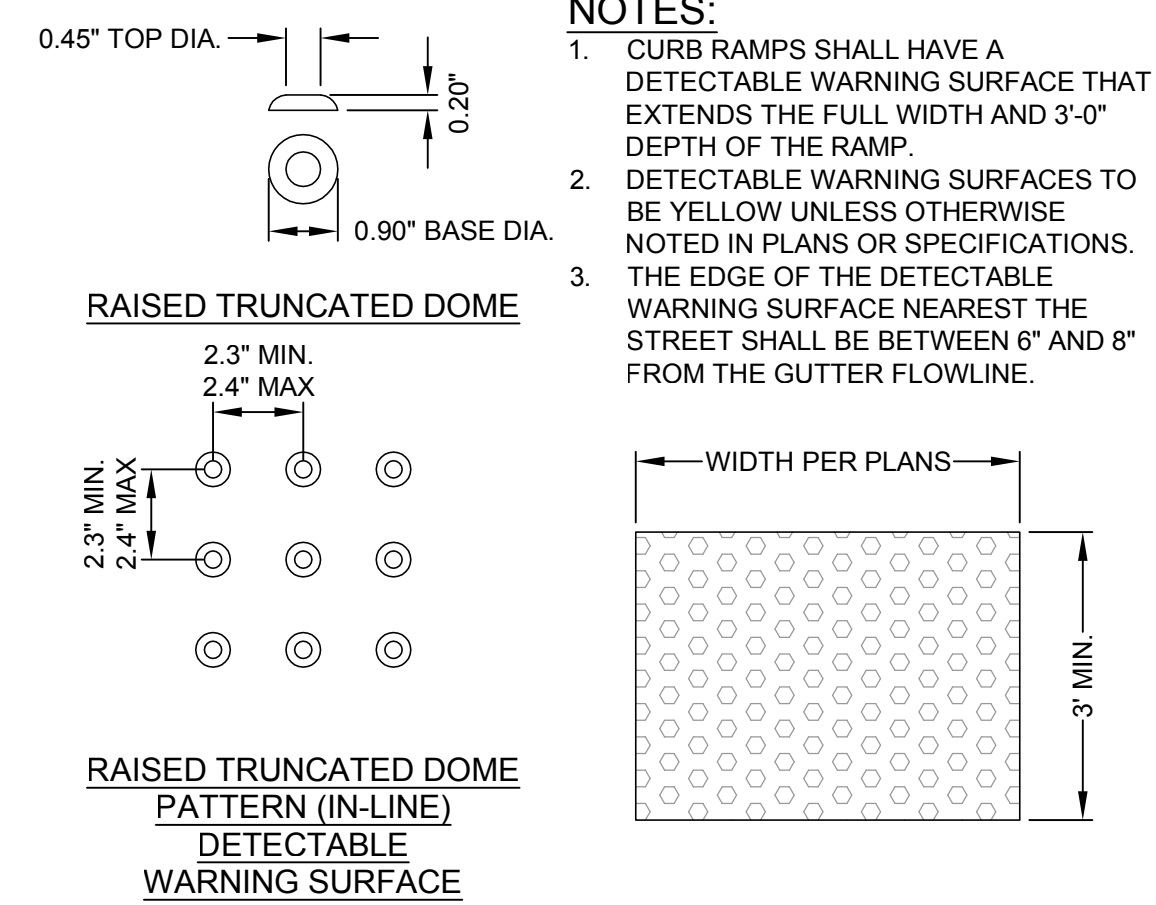

4 DETECTABLE WARNING SURFACE
SCALE: N.T.S.

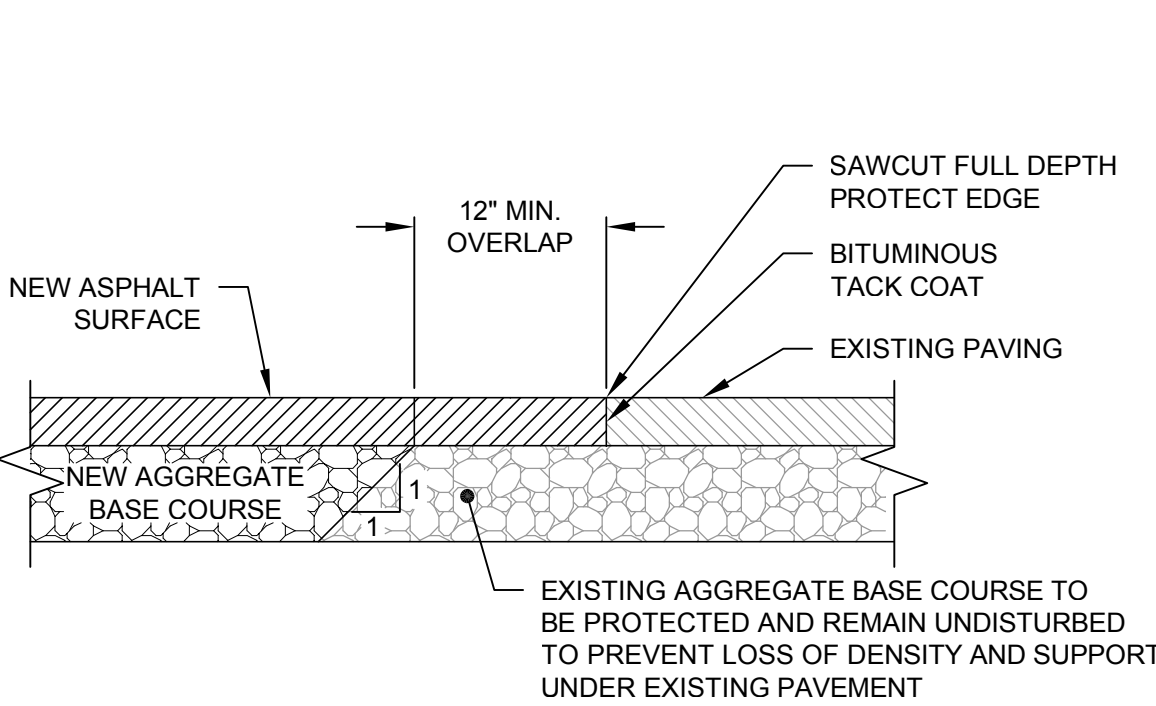

5 ASPHALT PAVEMENT SAWCUT/CONFORM
SCALE: 1" = 1'

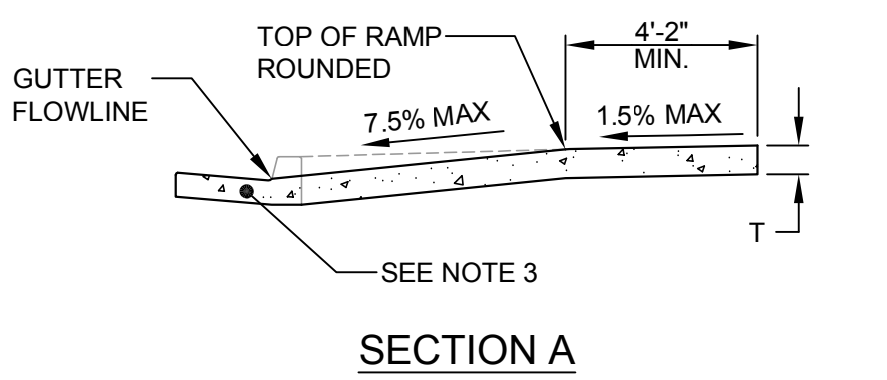
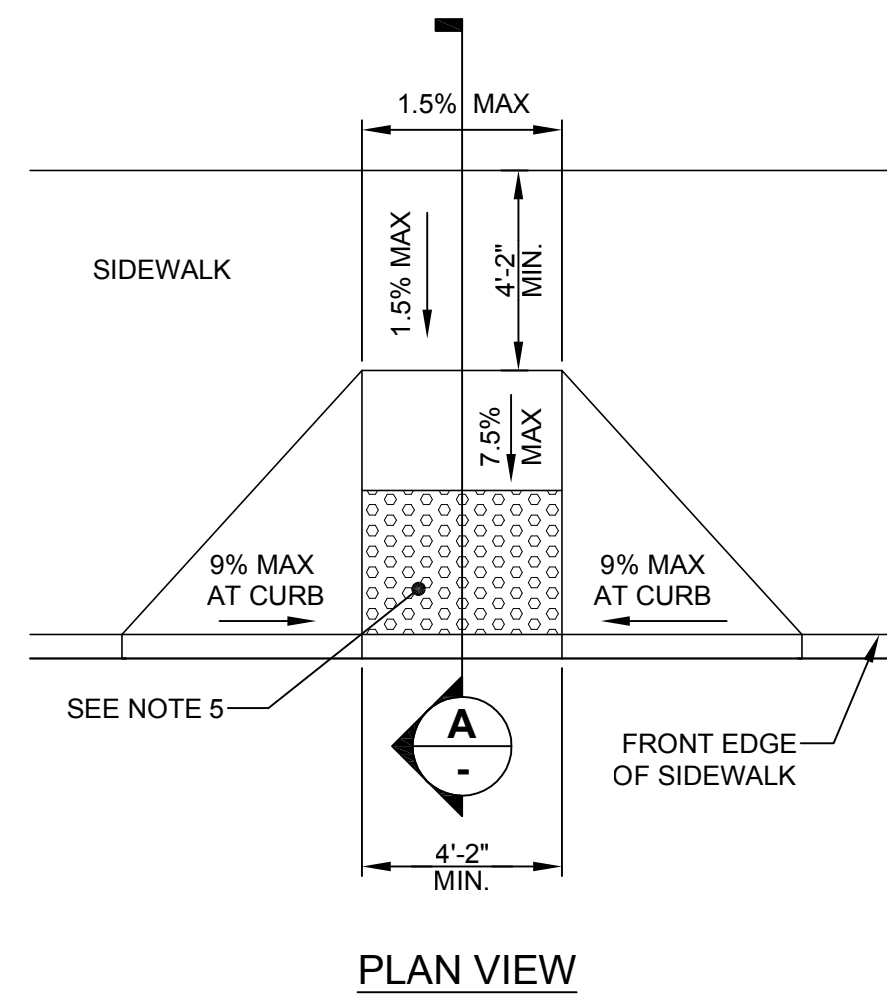

6 CASE "A" CURB RAMP (PER CALTRANS STD. RSP A88A)
SCALE: 1/4" = 1'

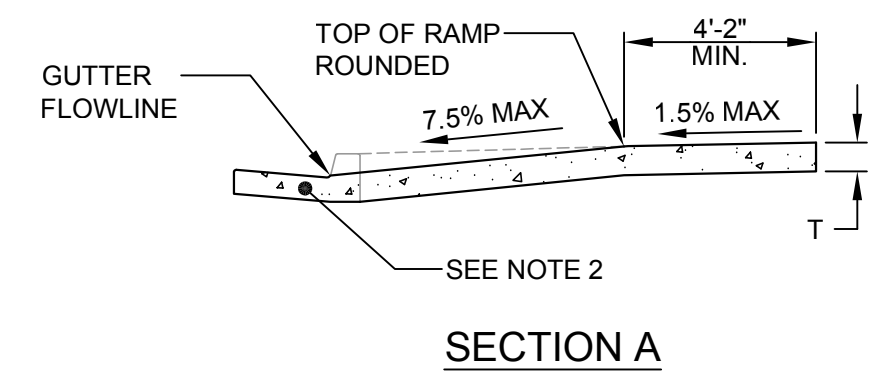
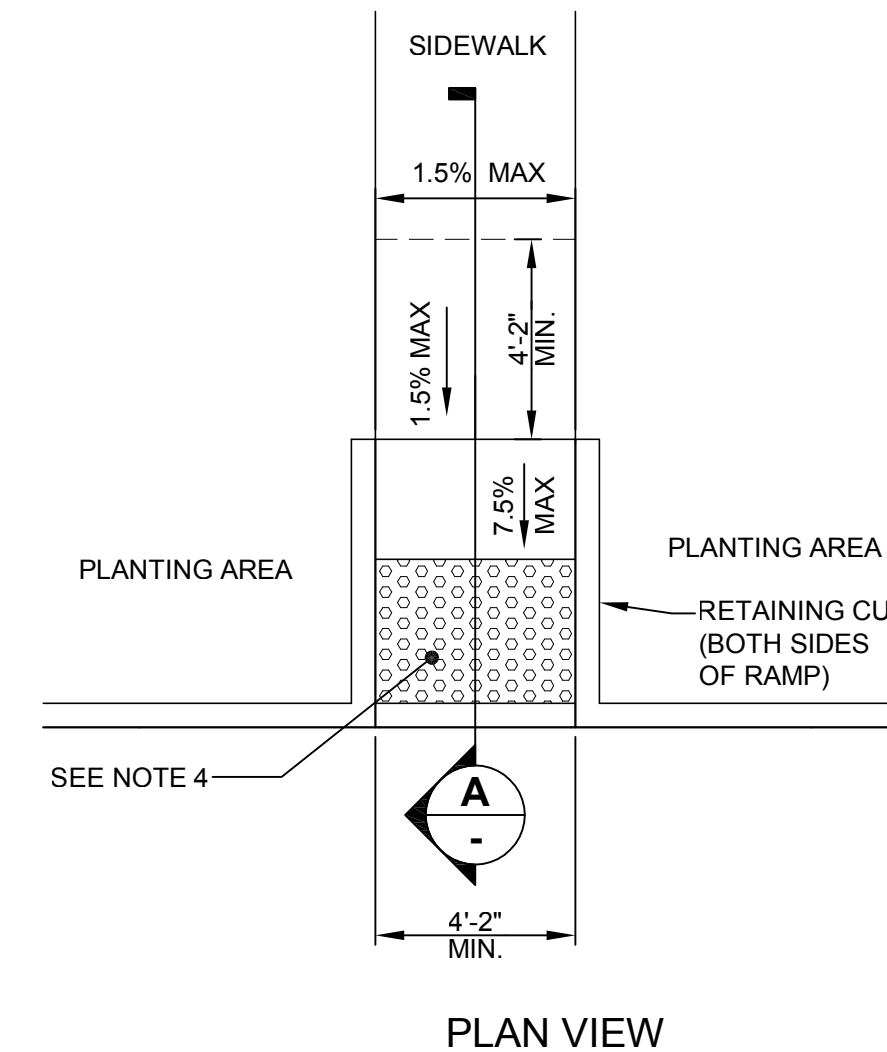

7 CASE "F" CURB RAMP (PER CALTRANS STD. RSP A88A)
SCALE: 1/4" = 1'

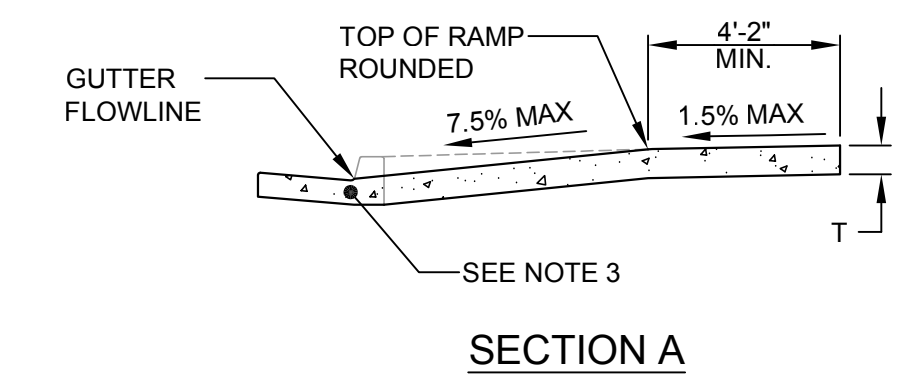
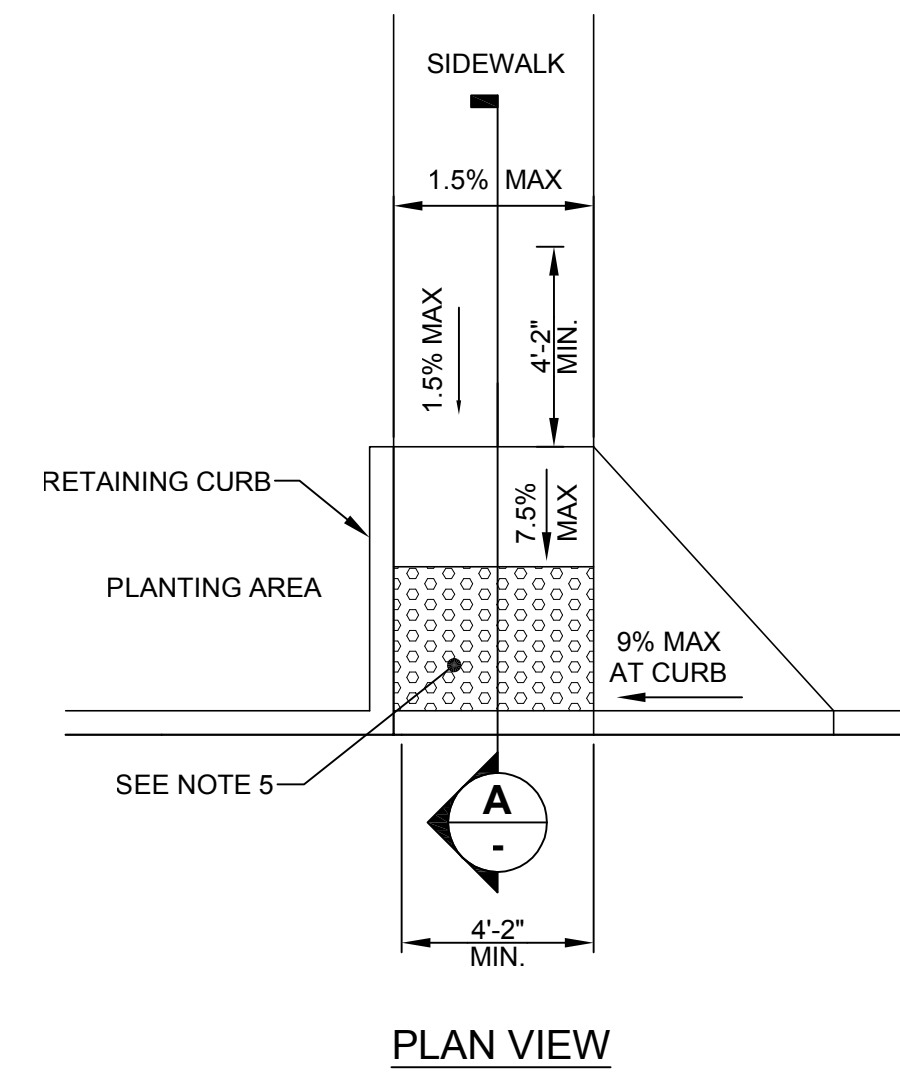

8 CASE "G" CURB RAMP (PER CALTRANS STD. RSP A88A)
SCALE: 1/4" = 1'

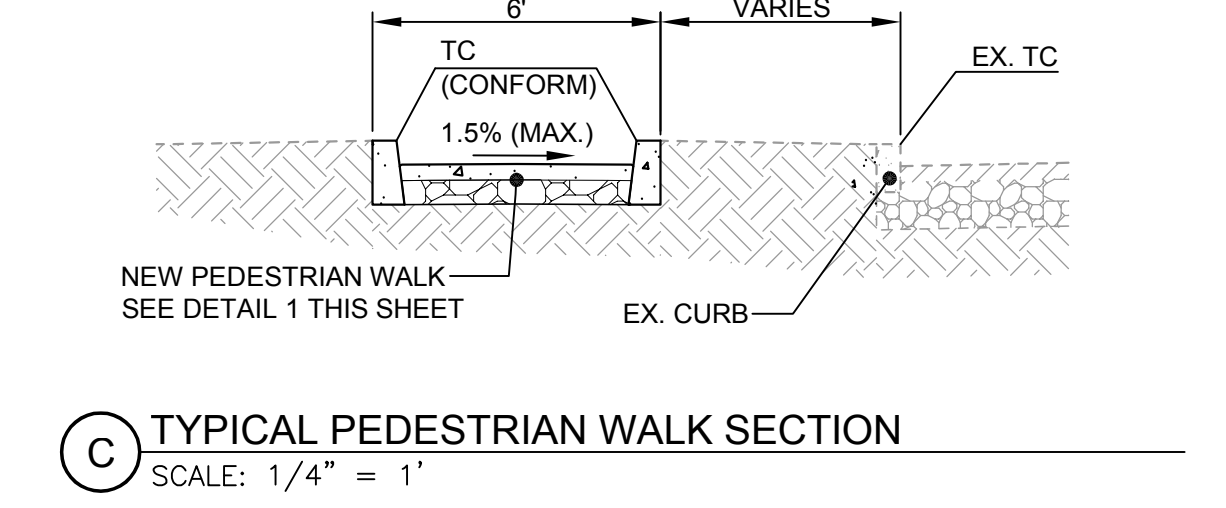
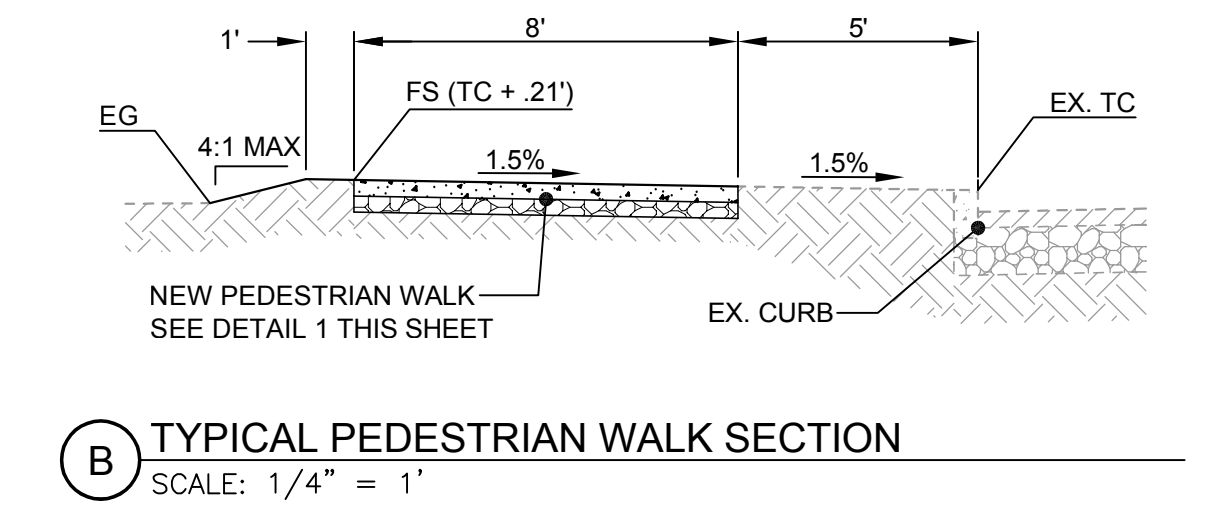
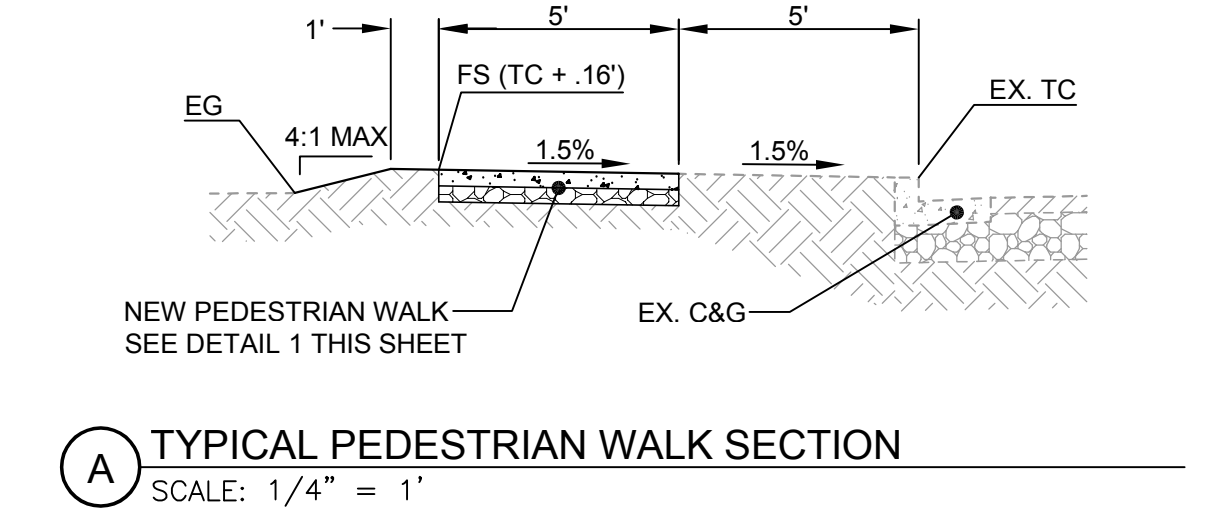

- NOTES:**
- IF LOCATED ON A CURVE, THE SIDES OF RAMP NEED NOT BE PARALLEL, BUT THE MINIMUM WIDTH OF THE RAMP SHALL BE 4'-2".
 - SIDE SLOPE OF RAMP FLARES VARY UNIFORMLY FROM A MAXIMUM OF 9% AT CURB TO CONFORM WITH LONGITUDINAL SIDEWALK SLOPE ADJACENT TO TOP OF RAMP.
 - TRANSITIONS FROM RAMPS AND LANDINGS TO WALKS, GUTTERS OR STREETS SHALL BE FLUSH AND FREE OF ABRUPT CHANGES.
 - COUNTER SLOPES OF ADJOINING GUTTERS AND ROAD SURFACES IMMEDIATELY ADJACENT TO AND WITHIN 24 INCHES OF THE CURB RAMP SHALL NOT BE STEEPER THAN 1:20 (5.0%). GUTTER PAN SLOPE SHALL NOT EXCEED 1" OF DEPTH FOR EACH 2'-0" OF WIDTH.
 - CURB RAMPS SHALL HAVE A DETECTABLE WARNING SURFACE THAT EXTENDS THE FULL WIDTH AND 3'-0" DEPTH OF THE RAMP. A 4'-0" WIDE DETECTABLE WARNING SURFACE MAY BE USED ON A 4'-2" WIDE CURB RAMP. DETECTABLE WARNING SURFACES SHALL CONFORM TO THE DETAILS ON THIS PLAN AND THE REQUIREMENTS IN THE SPECIAL PROVISIONS.
 - SIDEWALK AND RAMP THICKNESS, "T", SHALL BE 3/2" MINIMUM U.N.O.
 - UTILITY PULL BOXES, MANHOLES, VAULTS AND ALL OTHER UTILITY FACILITIES WITHIN THE BOUNDARIES OF THE CURB RAMP WILL BE RELOCATED OR ADJUSTED TO GRADE BY THE OWNER PRIOR TO OR IN CONJUNCTION WITH CURB RAMP CONSTRUCTION.
 - FOR RETROFIT CONDITIONS, REMOVAL AND REPLACEMENT OF CURB APRON WILL BE AT THE CONTRACTOR'S OPTION, U.N.O.
 - DETECTABLE WARNING SURFACE MAY HAVE TO BE CUT TO ALLOW REMOVAL OF UTILITY COVERS WHILE MAINTAINING FULL DETECTABLE WARNING WIDTH AND DEPTH.

- NOTES:**
- IF LOCATED ON A CURVE, THE SIDES OF RAMP NEED NOT BE PARALLEL, BUT THE MINIMUM WIDTH OF THE RAMP SHALL BE 4'-2".
 - SIDE SLOPE OF RAMP FLARES VARY UNIFORMLY FROM A MAXIMUM OF 9% AT CURB TO CONFORM WITH LONGITUDINAL SIDEWALK SLOPE ADJACENT TO TOP OF RAMP.
 - TRANSITIONS FROM RAMPS AND LANDINGS TO WALKS, GUTTERS OR STREETS SHALL BE FLUSH AND FREE OF ABRUPT CHANGES.
 - COUNTER SLOPES OF ADJOINING GUTTERS AND ROAD SURFACES IMMEDIATELY ADJACENT TO AND WITHIN 24 INCHES OF THE CURB RAMP SHALL NOT BE STEEPER THAN 1:20 (5.0%). GUTTER PAN SLOPE SHALL NOT EXCEED 1" OF DEPTH FOR EACH 2'-0" OF WIDTH.
 - CURB RAMPS SHALL HAVE A DETECTABLE WARNING SURFACE THAT EXTENDS THE FULL WIDTH AND 3'-0" DEPTH OF THE RAMP. A 4'-0" WIDE DETECTABLE WARNING SURFACE MAY BE USED ON A 4'-2" WIDE CURB RAMP. DETECTABLE WARNING SURFACES SHALL CONFORM TO THE DETAILS ON THIS PLAN AND THE REQUIREMENTS IN THE SPECIAL PROVISIONS.
 - SIDEWALK AND RAMP THICKNESS, "T", SHALL BE 3/2" MINIMUM U.N.O.
 - UTILITY PULL BOXES, MANHOLES, VAULTS AND ALL OTHER UTILITY FACILITIES WITHIN THE BOUNDARIES OF THE CURB RAMP WILL BE RELOCATED OR ADJUSTED TO GRADE BY THE OWNER PRIOR TO OR IN CONJUNCTION WITH CURB RAMP CONSTRUCTION.
 - FOR RETROFIT CONDITIONS, REMOVAL AND REPLACEMENT OF CURB APRON WILL BE AT THE CONTRACTOR'S OPTION, U.N.O.
 - DETECTABLE WARNING SURFACE MAY HAVE TO BE CUT TO ALLOW REMOVAL OF UTILITY COVERS WHILE MAINTAINING FULL DETECTABLE WARNING WIDTH AND DEPTH.

Rev	Date	Description	Designed	Drawn	Checked
-	06/19/17	ISSUED FOR BID/NOT FOR CONSTRUCTION	SAS	SAS	KSB

CSW ST2
CSW/Stuber-Stroeh Engineering Group, Inc.
 Civil & Structural Engineers | Surveying & Mapping | Environmental Planning
 Land Planning | Construction Management
 45 Leveroni Court Novato, CA 94949
 tel: 415.883.9850 fax: 415.883.9835
 http://www.cswst2.com © 2017

City	FAIRFIELD
County	SOLANO
State	CALIFORNIA

SOLANO COMMUNITY COLLEGE
DETAILS AND SECTIONS
FAIRFIELD CAMPUS ENTRY SIDEWALK IMPROVEMENT PROJECT

Prepared Under the Direction of:	Sheet
	C2.0
Scale:	N.T.S.
Date:	02/09/17
Project Number:	4116410
Plan File:	D-5348.04

P:\04116410\Drawings\Sheet_Details\C2.0 - DETAILS.dwg 05/12/2017 - 01:58 PM User: 11

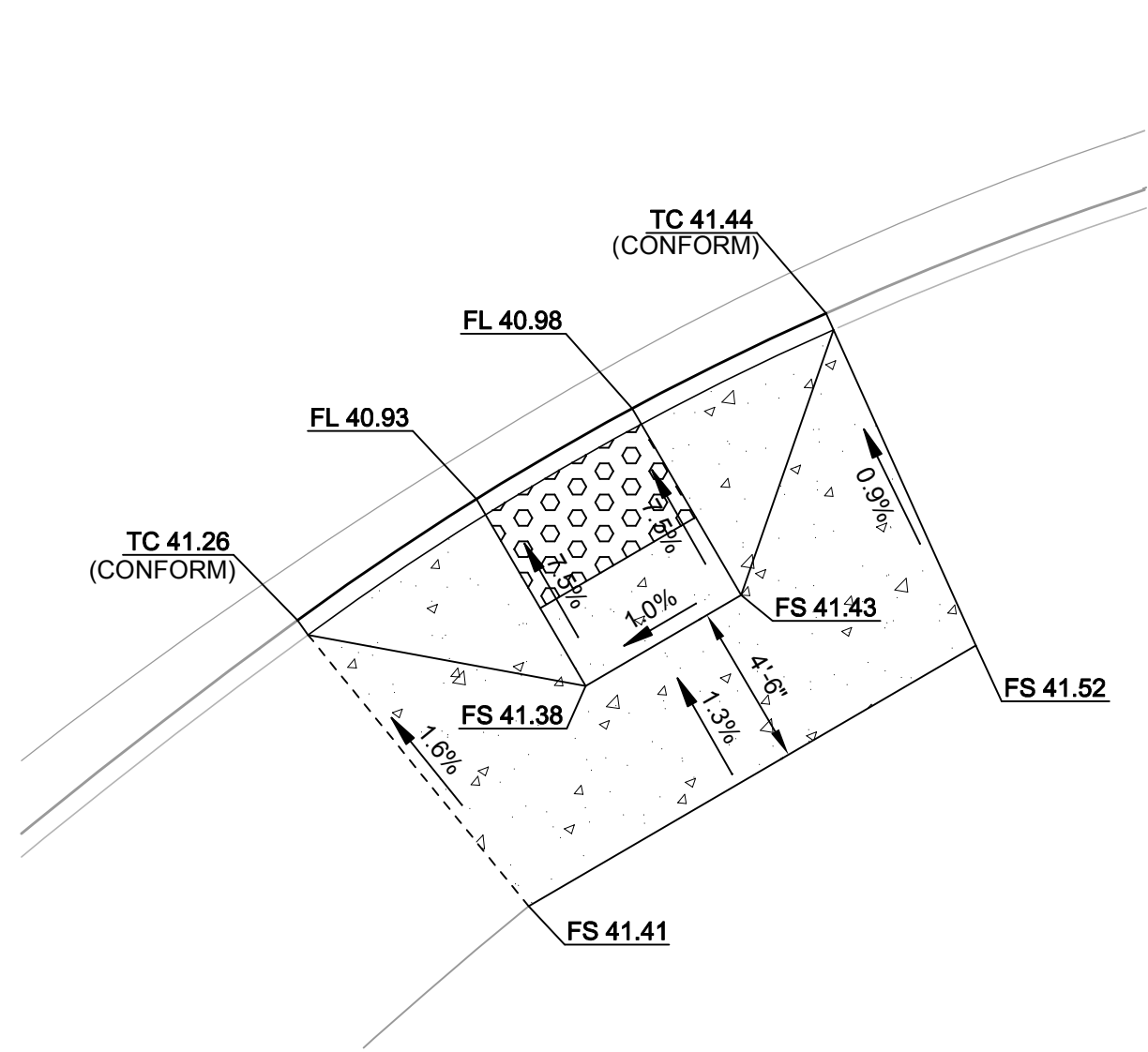

A CURB RAMP DETAIL (CASE "A")
SCALE: 1" = 5'

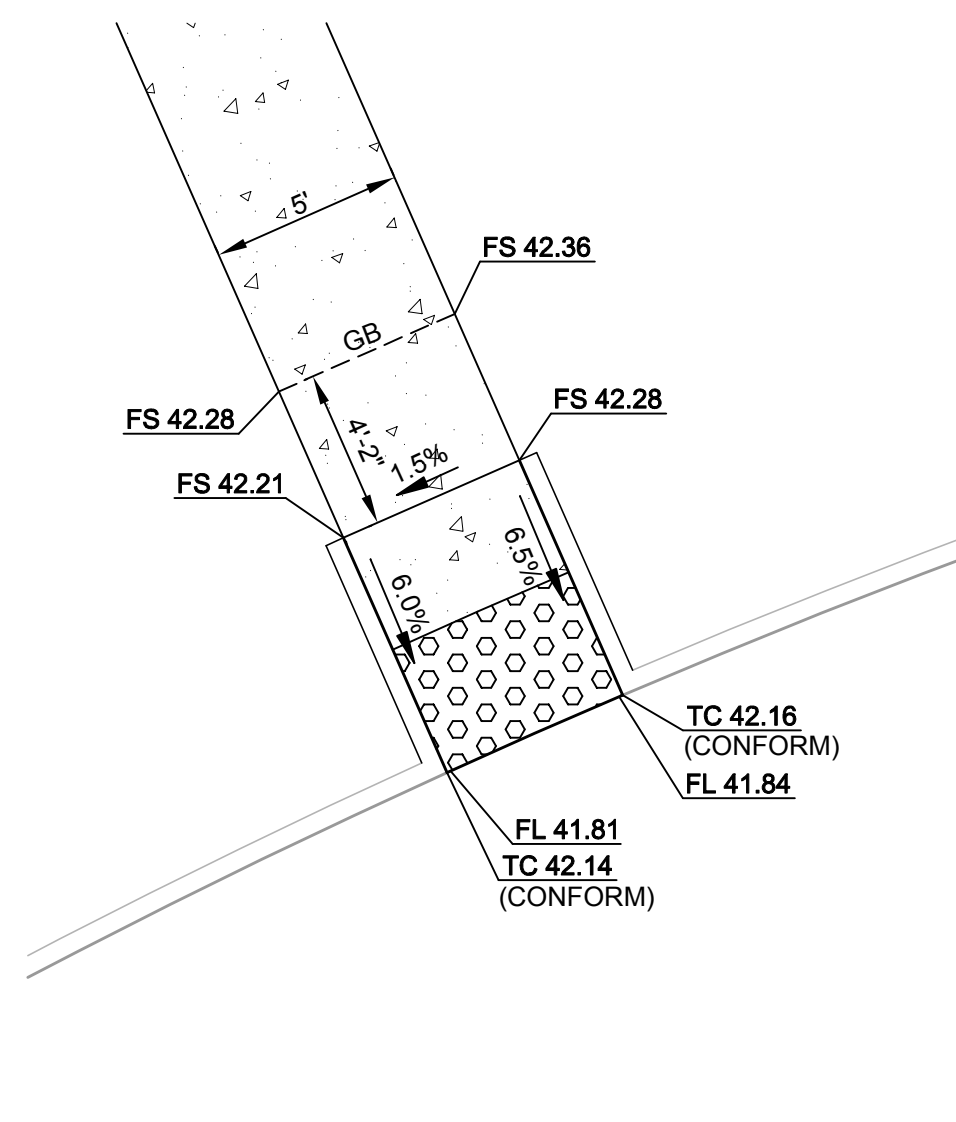

B CURB RAMP DETAIL (CASE "F")
SCALE: 1" = 5'

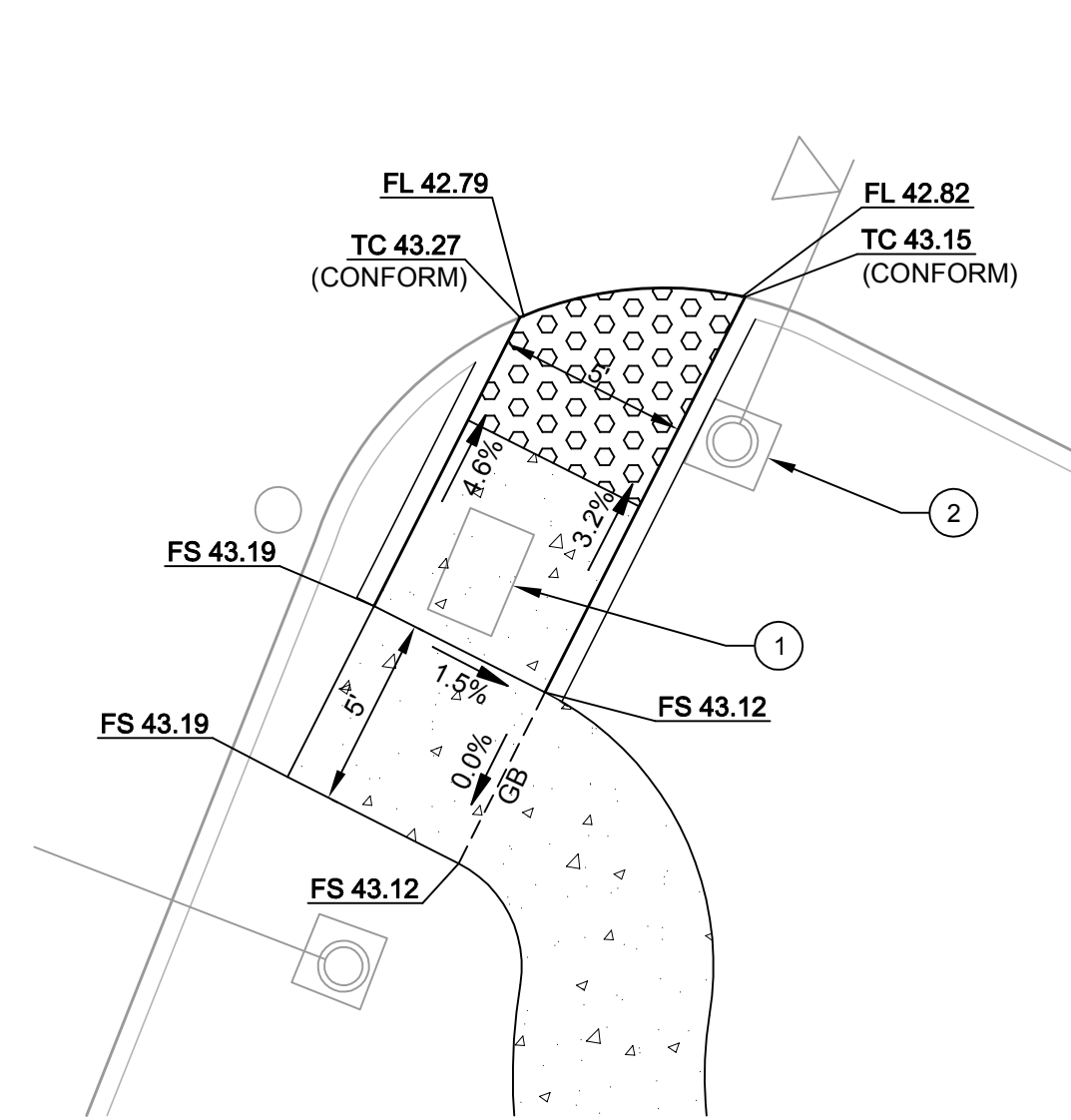

C CURB RAMP DETAIL (CASE "F")
SCALE: 1" = 5'

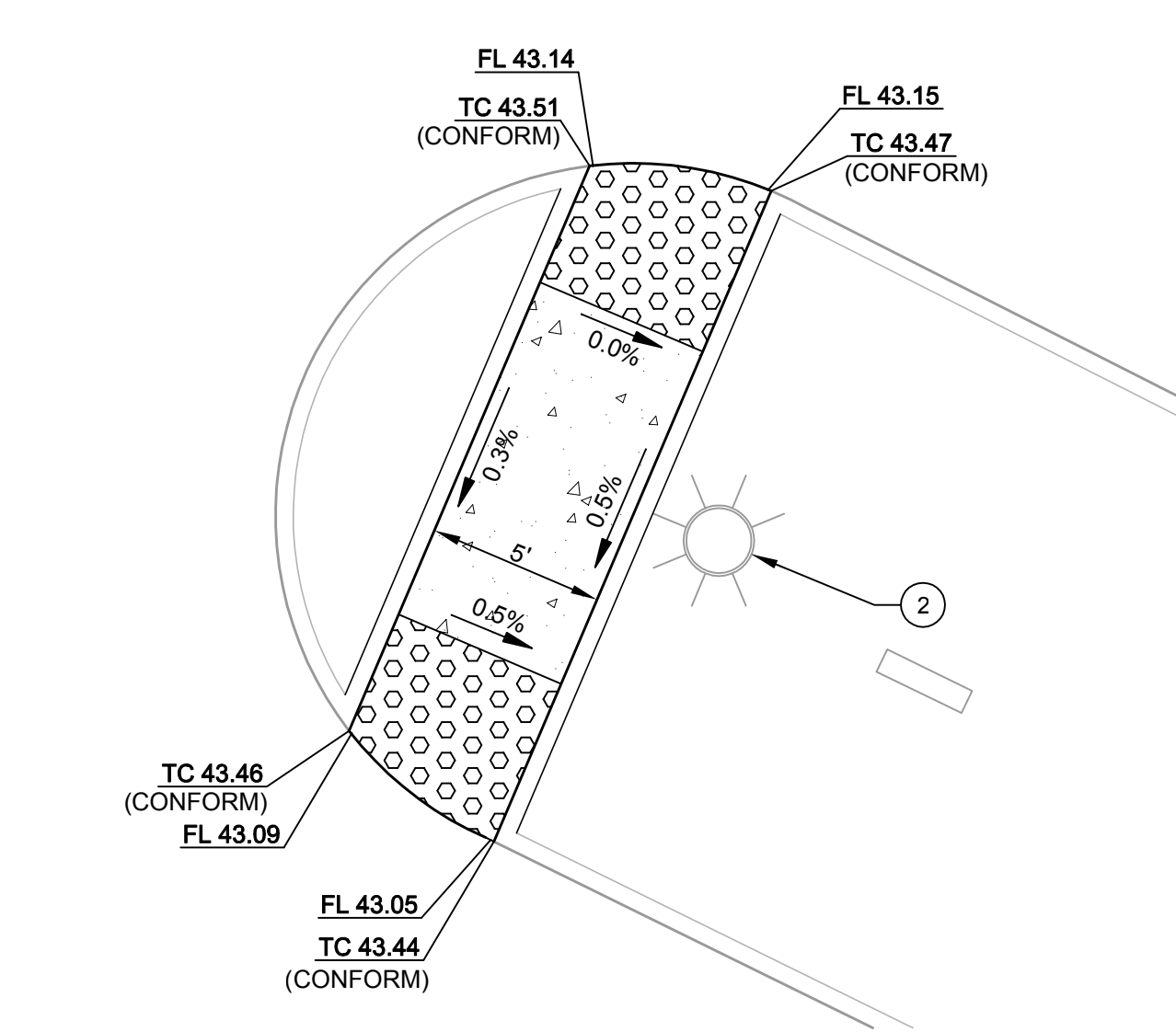

D PEDESTRIAN REFUGE AREA AT ISLAND DETAIL
SCALE: 1" = 5'

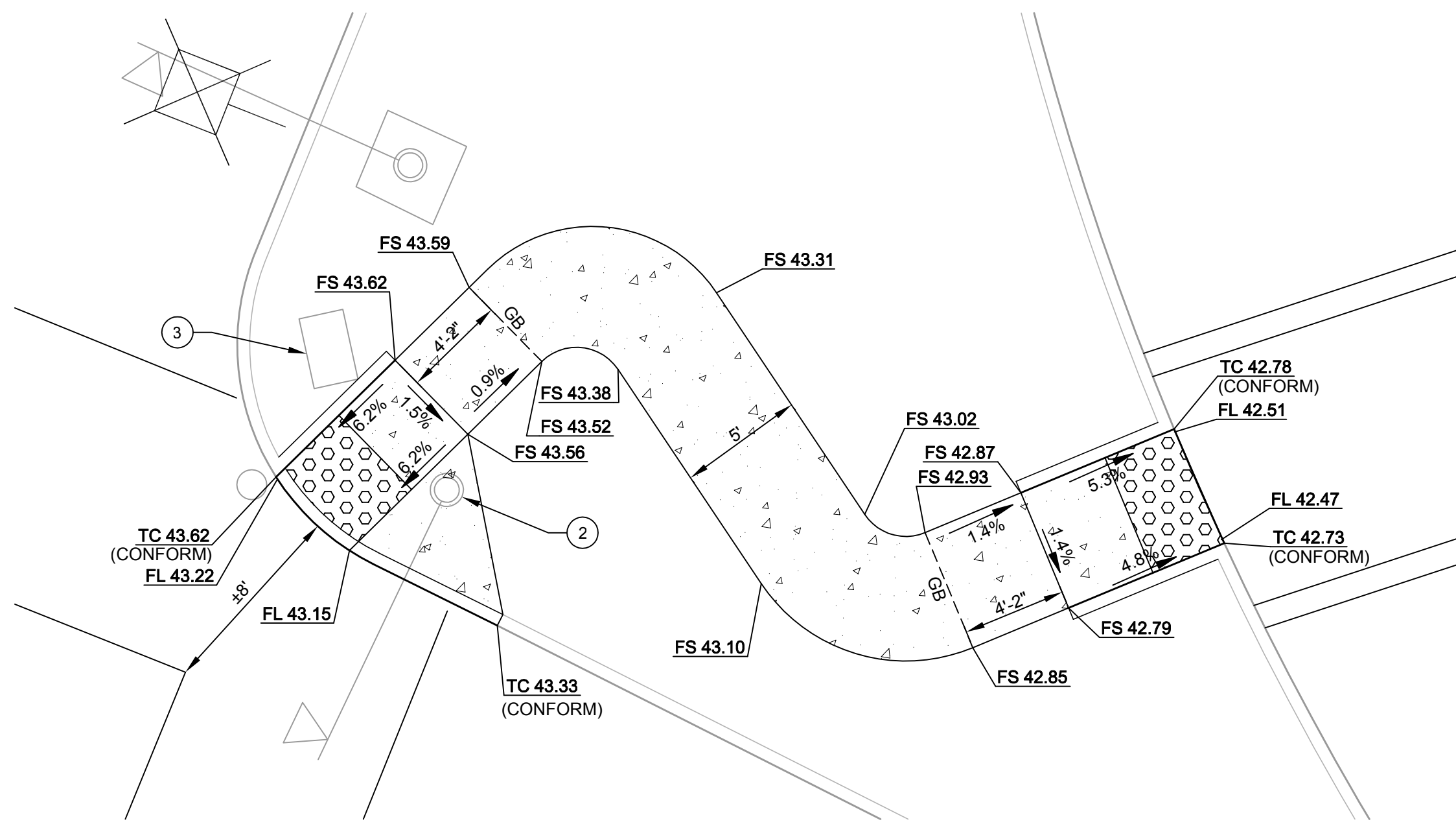

E CURB RAMP DETAIL (CASE "G" AND CASE "F")
SCALE: 1" = 5'

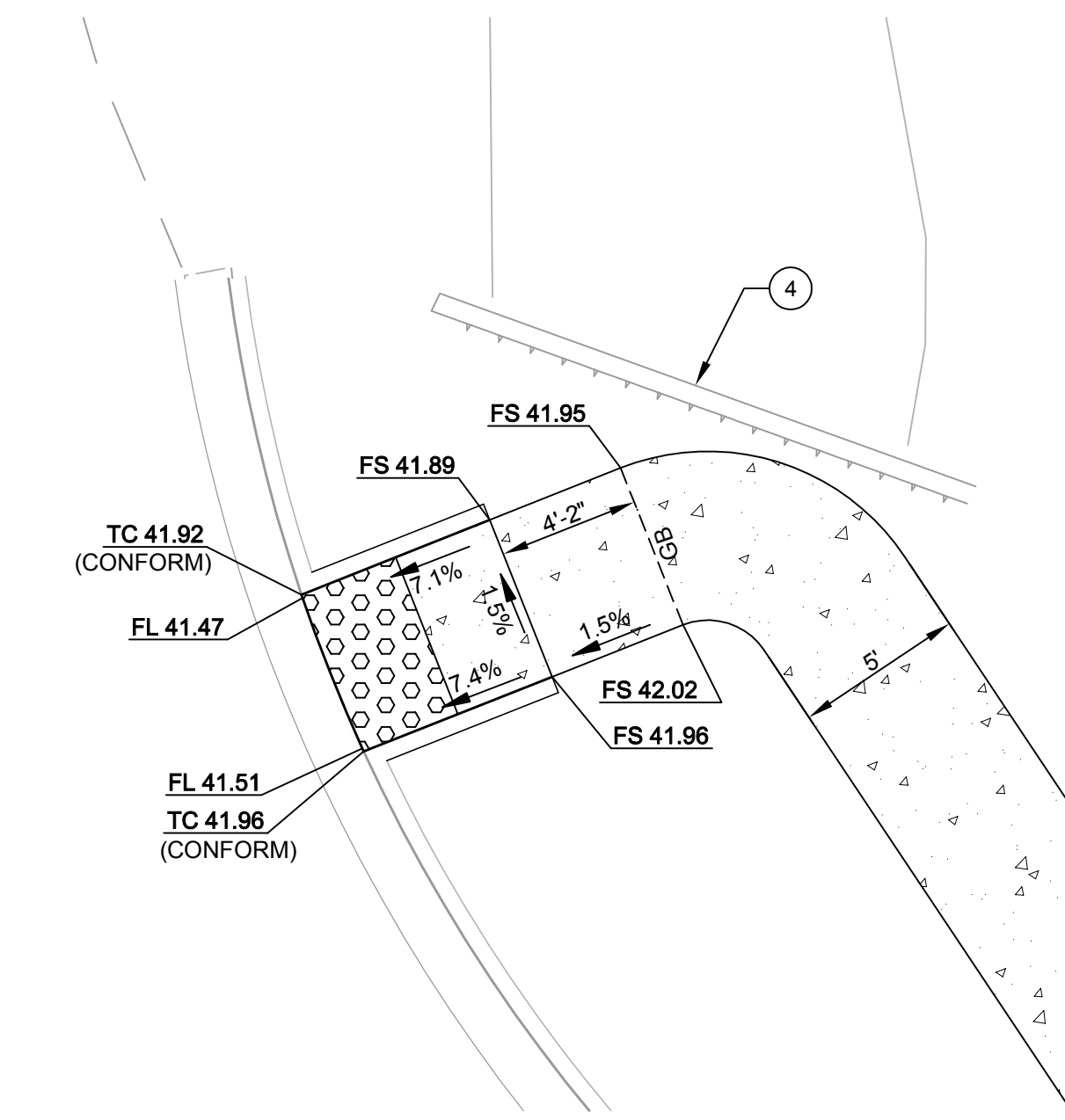

F CURB RAMP DETAIL (CASE "F")
SCALE: 1" = 5'

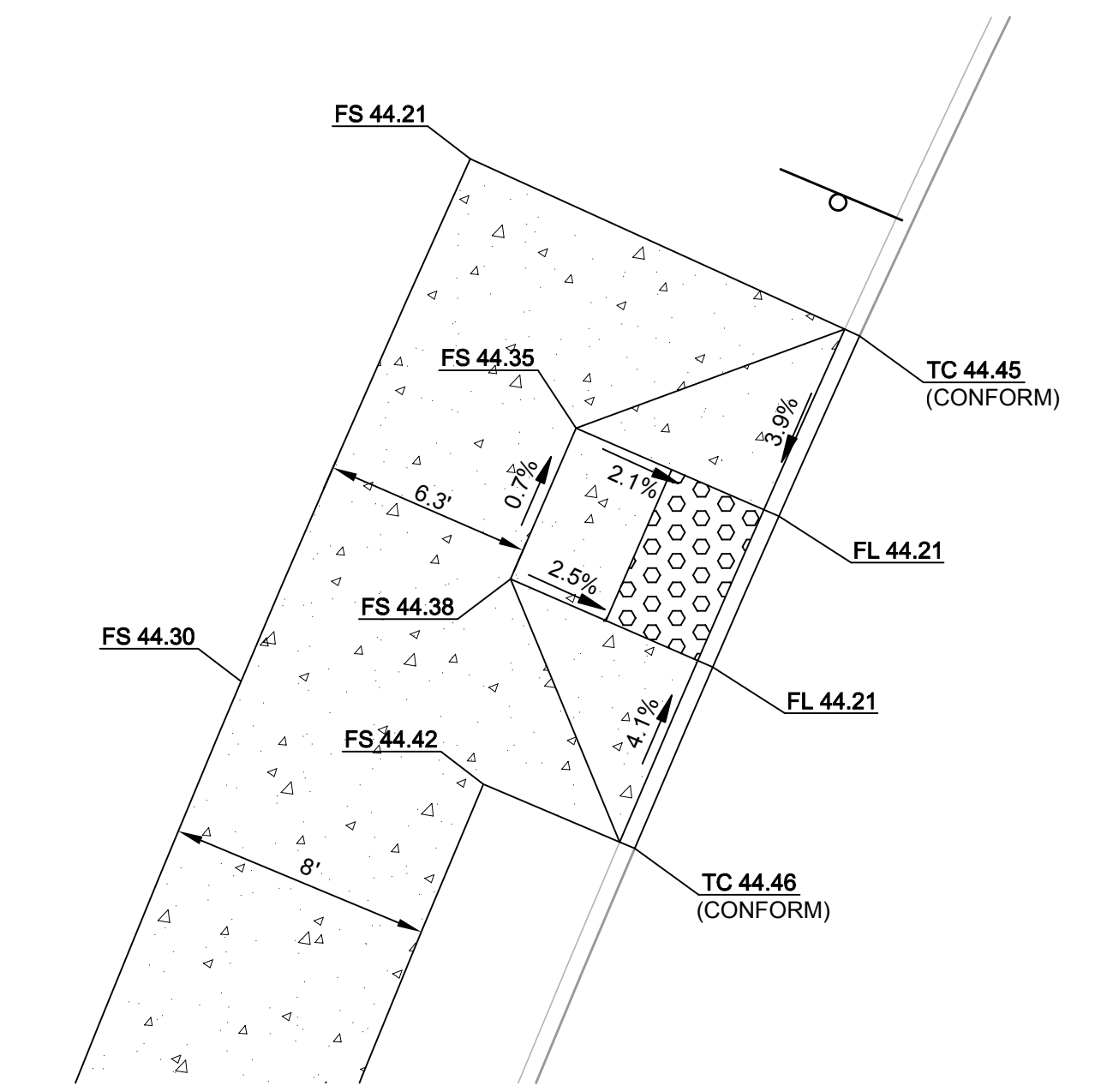

G CURB RAMP DETAIL (CASE "A")
SCALE: 1" = 5'

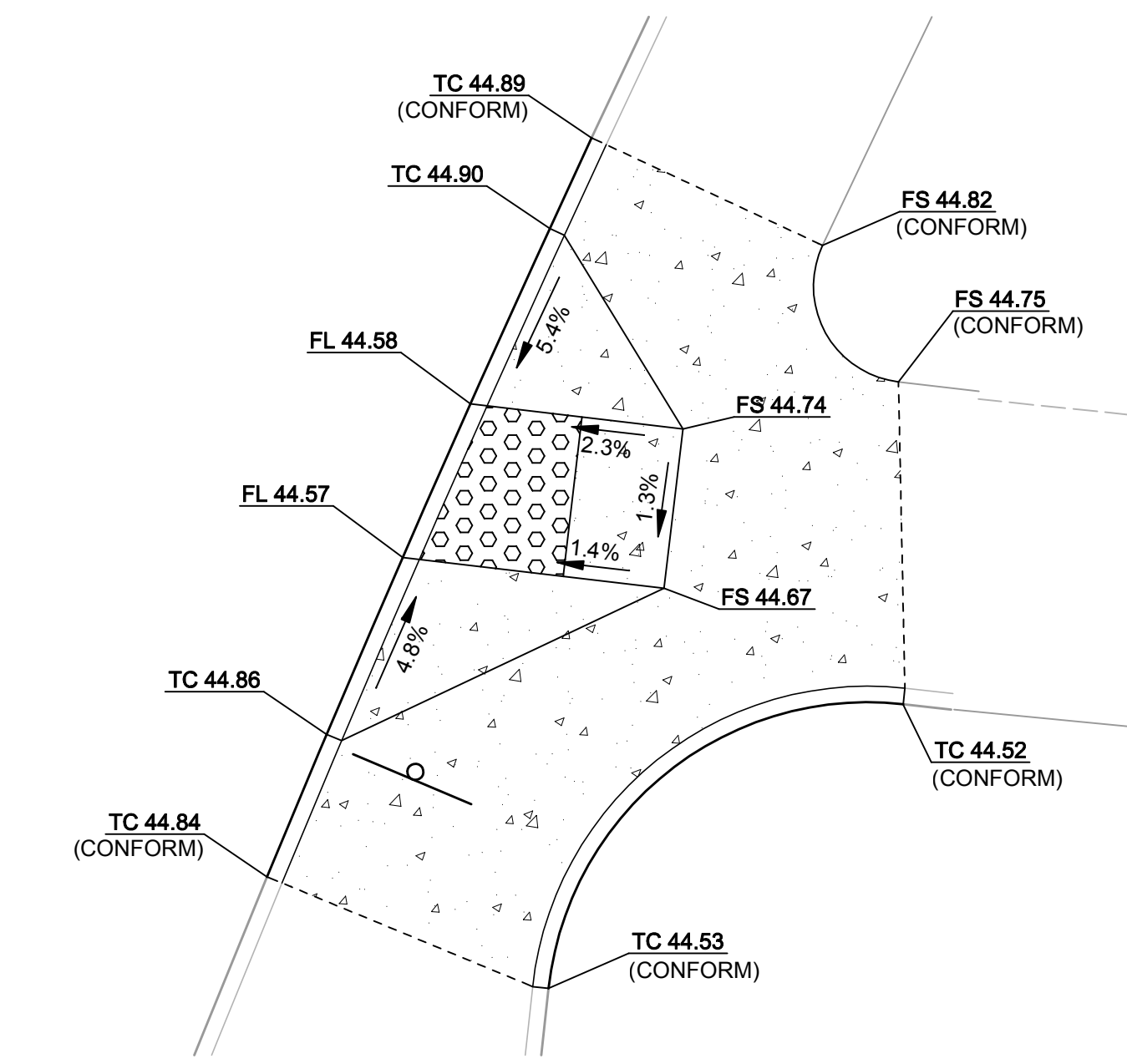

H CURB RAMP DETAIL (CASE "A")
SCALE: 1" = 5'

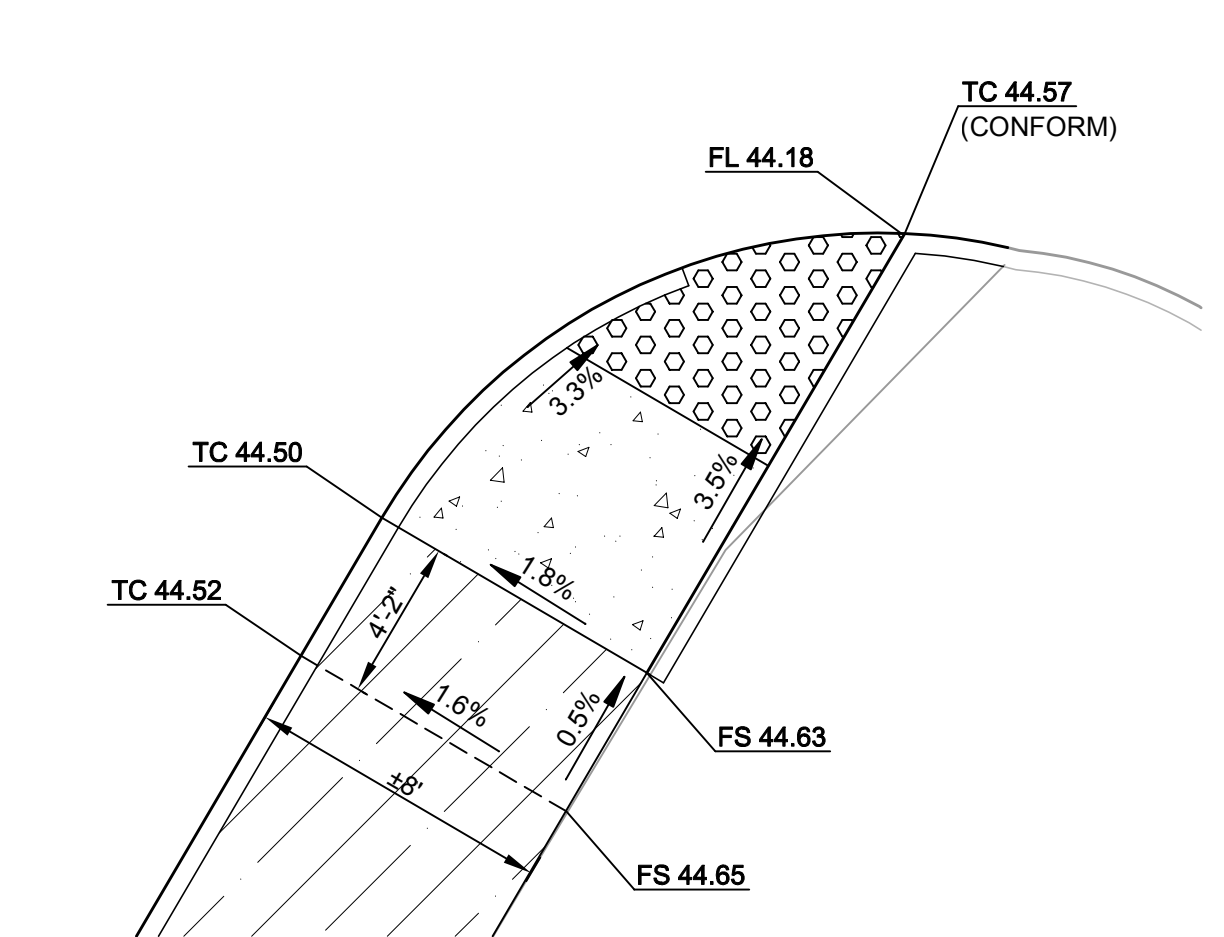

I CURB RAMP DETAIL (CASE "F")
SCALE: 1" = 5'

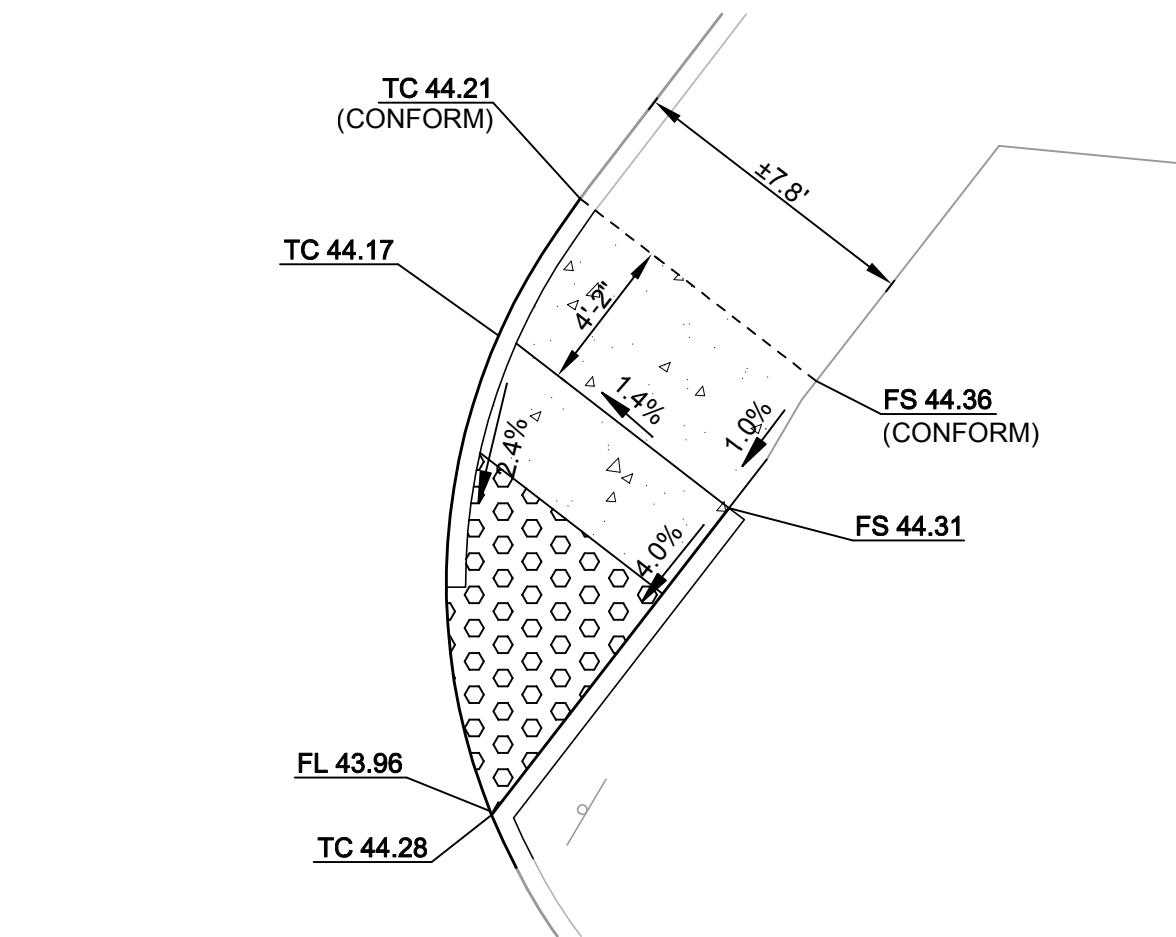

J CURB RAMP DETAIL (CASE "F")
SCALE: 1" = 5'

KEYNOTES

- 1 ADJUST EXISTING UTILITY BOX TO NEW FINISH GRADE
- 2 PROTECT EXISTING SIGNAL / LIGHT POLE IN PLACE
- 3 PROTECT EXISTING SIGNAL BOX TO REMAIN IN PLACE
- 4 PROTECT EXISTING HEADWALL

Rev	Date	Description	Designed	Drawn	Checked
-	06/19/17	ISSUED FOR BID/NOT FOR CONSTRUCTION	SAS	SAS	KSB

CSW | ST2
CSW/Stuber-Stroeh Engineering Group, Inc.
 Civil & Structural Engineers | Surveying & Mapping | Environmental Planning
 Land Planning | Construction Management
 45 Leveroni Court | Novato, CA 94949 | tel: 415.883.9850 | fax: 415.883.9835
<http://www.cswst2.com> | © 2017

City	FAIRFIELD	SOLANO COMMUNITY COLLEGE CURB RAMP GRADING AND LAYOUT DETAILS FAIRFIELD CAMPUS ENTRY SIDEWALK IMPROVEMENT PROJECT	Prepared Under the Direction of:	Sheet
County	SOLANO		C2.1	Scale: 1" = 20'
State	CALIFORNIA			Date: 02/09/17
			Project Number: 4116410	Plan File: D-5348.02

F:\04116410\Drawings\Sheet_Drawing\C2.1_CURBING DETAILS.dwg 06/15/2017 10:01 PM asha 1:1